

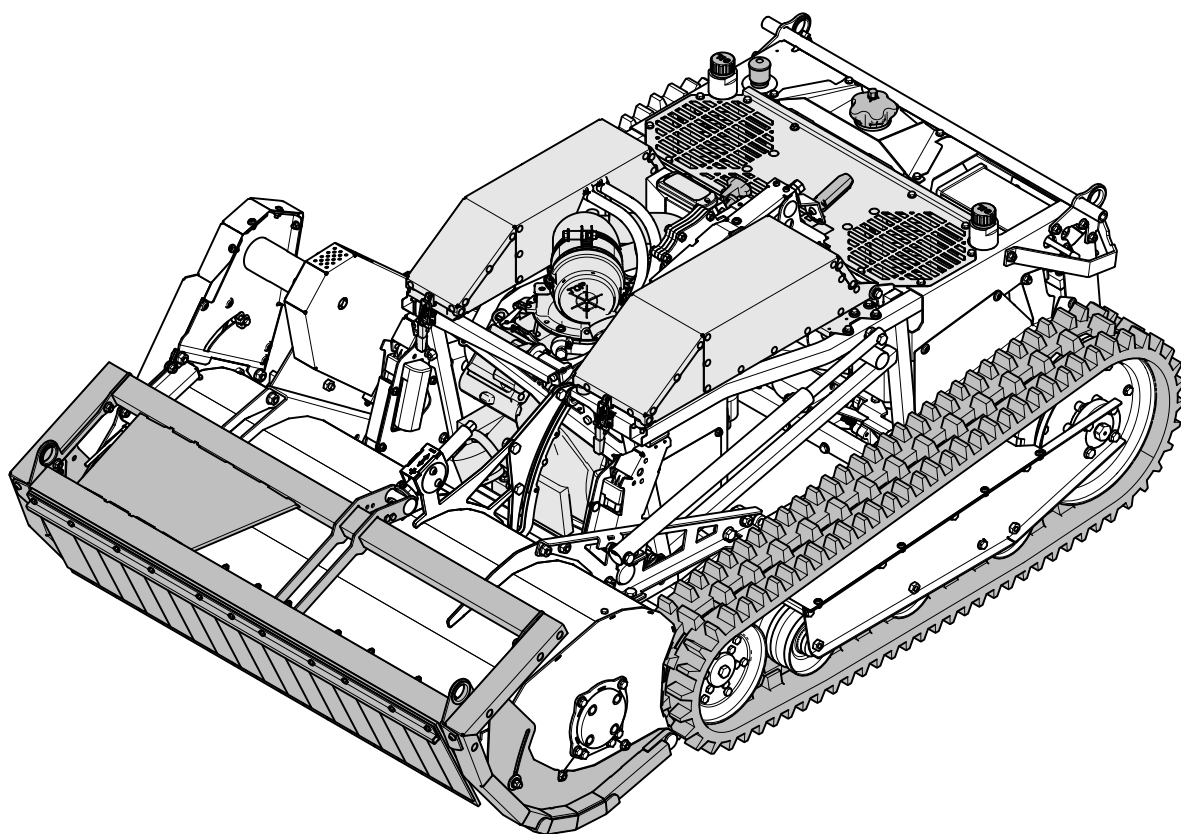

## Operator's Manual



### Remote control mower AS 1000 OVIS EVO RC

From serial number: 040724110001  
Issued: 24 Jan 2025, V1.0  
en-Translation of the Original Operator's Manual

### Notes on the operating manual

Dear customer,

Congratulations on your purchase. You have acquired a reliable quality product of the „AS-Motor“ brand.

This product has been manufactured according to modern manufacturing methods and comprehensive quality assurance measures. Only when you are satisfied with your device have we attained our goal.

These operating instructions contain important information to help you avoid hazards and to increase the reliability and the life span of the device.



Read the operator's manual before using the device. Share this operator's manual and the operator's manual of the engine manufacturer with other users of the device.

### Contact

If you have questions about your device, please contact your customer service.

For international partners, please see: [www.as-motor.com](http://www.as-motor.com).

### Device data

Please fill in all data referring to your device. When ordering spare parts, provide your dealer with the serial and engine numbers.

Serial number (see manufacturer's certificate or type plate):

Engine number:

Date of purchase:

Address of dealer:

### Intended use

The device is intended for cutting and mulching grass or similar vegetation in agriculture, and forestry. Woody growth must not be older than maximally one year.

The device is intended for use by instructed users. These users must be able, due to their knowledge and experience, to use the device and detect and avoid possible dangers of their own.

Only use accessories and cutting tools that have been approved by the manufacturer.

Any other use exceeding this purpose is inadmissible.

Observe the instructions in chapter "Maintenance". Otherwise, operational safety is endangered.

The user of the device is responsible for accidents or damage that can happen to other persons or their property!

In particular, the device **must not** be used:

- as a toy.
- to transport people.
- to cut hard objects, stones, rubble, or pieces of wood.
- to trim bushes, hedges, and shrubbery.
- to cut plants in balcony boxes or containers or on roofs.
- as shredder for shredding tree and hedge cuttings.
- as drive unit for working tools and any type of tool sets that are not authorised by the manufacturer.

The device is not licensed for driving on public roads.

## Contents

<b>Notes on the operating manual</b> .....	<b>2</b>	<b>Transport</b> .....	<b>25</b>
<b>Contact</b> .....	<b>2</b>	Transport on pallets .....	25
<b>Device data</b> .....	<b>2</b>	Transport of ready-to-use device .....	25
<b>Intended use</b> .....	<b>2</b>	Moving the device without drive .....	26
<b>Explanation of the symbols</b> .....	<b>4</b>	<b>Maintenance</b> .....	<b>26</b>
Symbols in the instructions .....	4	Maintenance overview .....	27
Warnings .....	4	Maintenance and cleaning position .....	29
Signs on the device .....	4	Cleaning the device .....	29
<b>Safety instructions</b> .....	<b>6</b>	General inspection .....	30
Get informed! .....	6	Check receiver and Remote Control Transmitter .....	30
User restrictions and hours of operation .....	6	Checking main switch .....	30
Safe handling of fuel .....	6	Checking the safety functions .....	30
Check the device prior to use .....	6	Checking the RC functions .....	31
Use caution during operation .....	7	Checking the parking brake .....	32
Prior to mowing .....	8	Checking the blade and flail shaft .....	32
Danger area .....	8	Checking the blade brake clutch .....	33
Driving on slopes .....	9	Checking chains .....	33
Increased risk of tipping with additional load .....	10	Maintaining the engine .....	34
Risk of injury due to unauthorised use .....	10	Checking the engine oil level .....	34
When work is completed .....	10	Check oil level of the bevel gear .....	35
Use caution during maintenance and repair .....	10	Maintaining the air filter .....	35
<b>Device description</b> .....	<b>11</b>	Checking and charging the battery .....	35
<b>Control elements on the device</b> .....	<b>12</b>	Hydrostat transmission .....	36
<b>Control elements on the transmitter</b> .....	<b>14</b>	Grease lubrication .....	36
Display on the Remote Control Transmitter .....	15	<b>Assembly</b> .....	<b>37</b>
More elements on the Remote Control Transmitter .....	15	Scope of delivery .....	37
<b>Elements on the receiver</b> .....	<b>16</b>	Unpacking .....	37
<b>Optical signals</b> .....	<b>16</b>	<b>Storage</b> .....	<b>37</b>
Status indicators on the device .....	16	Storing the device .....	37
<b>Acoustic signals</b> .....	<b>16</b>	Longer storage .....	37
Signals of the device .....	16	Restarting .....	37
<b>Safety functions</b> .....	<b>16</b>	<b>Spare parts</b> .....	<b>38</b>
<b>Information on mowing</b> .....	<b>16</b>	<b>Wear parts</b> .....	<b>38</b>
<b>Prior to starting</b> .....	<b>17</b>	<b>Disposal and recycling</b> .....	<b>38</b>
Checking the oil level .....	17	<b>Warranty</b> .....	<b>38</b>
Fuel .....	17	<b>Troubleshooting</b> .....	<b>39</b>
Tanking up .....	17	Error codes .....	42
Carrying the Remote Control Transmitter .....	17	<b>Technical specifications</b> .....	<b>43</b>
Checking and changing the battery of the transmitter .....	17	Fuses .....	45
Adjusting the sliders .....	18	<b>Accessories</b> .....	<b>46</b>
Setting the cutting height limitation .....	19	<b>Declaration of Conformity</b> .....	<b>47</b>
<b>Switching on receiver and transmitter</b> .....	<b>19</b>		
Selecting the radio channel .....	19		
<b>Training operation</b> .....	<b>20</b>		
<b>Operating</b> .....	<b>20</b>		
Starting the engine .....	20		
Steering and driving .....	21		
Driving on steep terrain .....	22		
Setting the cutting height .....	22		
Engaging blade .....	22		
Moving blade to transport position .....	23		
Switching off and parking .....	23		
Emergency stop .....	24		

## Explanation of the symbols

### Symbols in the instructions

The device is only as safe as its user. Carelessness, negligence or an operating error could result in severe injuries or death.

In these operating instructions, the following symbols are used to denote special dangers.



Warning.  
These symbols denote special dangers.



Prohibition sign.  
These symbols denote inadmissible procedures.



Directive sign.  
These symbols denote required protective measures.

### Symbols in the text

- 1. A numbered text requests you to act or shows a process sequence.
  - ⇒ An indented arrow marks the result of a step.
- ⇒ An arrow that is not indented refers to the result of a sequence of actions.

**Notice:** An additional piece of information is marked by the word "Notice" written in bold letters.

### Warnings

In these operating instructions, warnings are marked with signal word and colours. The signal words and colours out used to point to following hazards and potential consequences.

**Danger**

Imminent danger  
Indicates an imminently hazardous situation with a **high level of risk** that, if not avoided, **will** result in death or severe injury.

**Warning**

Hazardous situation  
Indicates a possibly hazardous situation with a **medium level of risk** that, if not avoided, **could** result in death or (severe) injury.

**Caution**

Hazardous situation  
Indicates a possibly hazardous situation with a **low level of risk** that, if not avoided, **could** result in minor or moderate injury.

**Notice**

Danger of property damage  
Indicates a possible risk of damage of the device and its surroundings.

### Signs on the device

The following signs are attached to the device to provide a reminder that during use of the device, you will have to be careful and attentive:



These operating instructions contain important information to help you avoid hazards and to increase the reliability and the life span of the device.  
Read the operator's manual before using the device.



Risk of injury!  
Make sure that no one is within the danger zone of the device. Objects may be ejected.

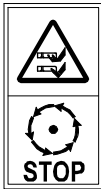

The quickly rotating blade can cause life threatening injuries or immense property damage! Be especially careful to keep your hands and feet away from the blade when the device is put into operation.

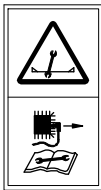

Prior to any repair and maintenance work, pull off the spark plug connector.



Prior to repair and maintenance work, pull off the key.



Danger of tipping when driving crosswise to the slope!  
Observe the safety instructions, especially those regarding the "Danger zone" and "Driving on slopes".



Danger of tipping when driving uphill and downhill!  
Observe the safety instructions, especially those regarding the "Danger zone" and "Driving on slopes".



Danger to life!  
On slopes, the device can topple over and slide towards you or run you over.  
Never stay below the device when on a slope.  
Observe the safety instructions, especially those regarding the "Danger zone" and "Driving on slopes".



Clean the ventilation grid! The cooling air of the motor is sucked in through the ventilation grid of the engine cover. Always keep the entire surface open and free!



Noise is causing health problems. Use personal ear protection to avoid hearing damage. Wear safety glasses.



Hot surface. Do not touch the engine or the muffler. These parts become very hot during operation and you can get burned.



Do not clean the device with water spray or high-pressure cleaner!



Check the engine oil level! Before and after each use, check the engine oil level.

## Type plate

The type plate on the device provides you with information on the device type and the technical data.

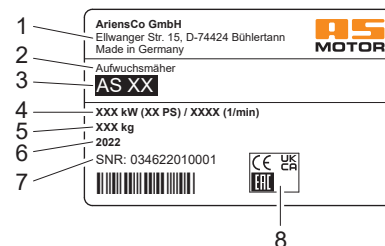

- 1 Name and address of the manufacturer
- 2 Device designation
- 3 Type designation
- 4 Rates power output in kW / engine speed
- 5 Weight
- 6 Year of manufacture
- 7 Serial number
- 8 Conformity marking

### Safety instructions

#### Get informed!

For your safety, read these operating instructions carefully. Familiarize yourself with the control elements and the proper use of the device. Failure to observe the safety information and instructions can result in serious injuries or fatal accidents. Share these operating instructions with other users of the device.

Before starting to work: Have skilled personnel show you the safe handling of the device.

Get familiar with the device in a wide, open and flat terrain first.

#### User restrictions and hours of operation

Never allow children or persons who are not familiar with the operator's manual to use the device. Persons under 18 years of age may operate the device only under proper supervision. Local regulations determine the minimum age of the operator and the operating times.

Unsuitable for operation of the device are persons who

- are under the influence of alcohol, drugs or reaction delaying medications.
- have physical and mental/emotional impairments.
- are tired or sick.



Persons with pace makers must not touch live parts of the ignition system.

#### Safe handling of fuel

Fuel is toxic and highly flammable. There is a burn and explosion hazard!

Keep fuel away from ignition sources and do not smoke during handling.

Do not inhale fuel vapours, they are dangerous to your health.

Use gloves and avoid skin contact with the fuel.

Always refuel outdoors when the engine is cold and stopped completely. When doing so, always use a filler spout or a funnel.

Do not spill any fuel or do not let fuel enter canalisation or drain away.

When fuel has overflowed, do not start the device until the fuel vapours have evaporated (wipe dry). Move the device away from the spilled fuel.

Always close the tank cap tightly and do not open it while the engine is running or the device is still hot.

Empty the fuel only when outdoors. Use the approved container for this or run the fuel tank empty.

Store the fuel away from children and keep it in a suitable container in a dark, cool and dry place.

Never store the device when there is fuel in the tank inside a building where fuel vapours might come into contact with open fire or sparks.

Immediately replace the fuel tank or tank cap if they are damaged (authorised service centre).

#### First aid

When swallowing fuel or inhaling fuel vapours, do not force vomiting and immediately consult a doctor.

In case of skin contact, immediately wash with water and soap. Change your soiled clothing as soon as you can.

#### Measures in case of a fire

In case of a fire, use foam, dry powder extinguisher, or carbon dioxide (CO<sub>2</sub>). Never douse with water!

#### Check the device prior to use

To ensure safe operation and to avoid hazards, injuries and damage, check the device before each use.

Visually check that the blade, protection skirt, impact protection, covers, ejection rubber, drive and fastening parts, cables and cable connections are in perfect condition and firmly seated.

Never use the device if covers, impact protection, ejection rubber or protection skirt are defective or not mounted.

Do not remove, change or override any safety devices or control elements.

Have an authorised service centre check your device if the blade does not stop within 7 seconds.

Observe the maintenance instructions (see chapter "Maintenance").

Visually check that the receiver and Remote Control Transmitter are in perfect condition.

Never use the device if the receiver or Remote Control Transmitter are damaged.

Prior to use, check the RC functions and safety functions of the device (see chapter "Maintenance") to ensure safe function of the device.

## Use caution during operation

Make sure that help can be provided in case of an emergency.

Only work during daylight or with adequate artificial lighting. Never work in the event of uncertain weather conditions and risk of lightning.

Be especially carefully when mowing on soft ground, nearby landfills, ditches, dikes and water edges.

Make sure that no persons, children or animals ride along.

Do not drive yourself on the device.

Only work when you have a clear view of the device and can fully oversee the danger area at all times.

### Danger of poisoning due to exhaust gases

Engine exhaust fumes contain carbon monoxide that can lead to serious health problems or death. Do not operate the engine in a closed room, even when all doors and windows are open and the room seems to be sufficiently ventilated.

Operate the engine only after you have moved the device to the outdoors.

Observe the information in the operator's manual of the engine manufacturer.

### Risk of injury when switching on

When switching on the device and the Remote Control Transmitter, there is a risk of injury. Device parts can move and cause crushing. Keep your hands and feet away from the rotating parts.

Make sure that no persons are in the immediate vicinity

- when you switch on the device using the main switch.

Exit the danger zone,

- Before you switch on the Remote Control Transmitter.
- Before you start the engine.

### Danger of injury during motor start

The engine must not be started:

- When fuel was spilled.
- When you or other persons are in close proximity.

### Risk of injury when the blade is running

The status indicator on the device flashes when the blade is switched on.

Switch off the blade and wait until the blade stops

- when you drive on surfaces other than the mowing area.
- when you do not mow.
- when you cannot completely view the area to be mowed.
- when the device must be manoeuvred out of a dangerous position.
- when the trafficability of the area to be mowed is too unsafe.

### Risk of injury when the motor is running

Switch off the engine, wait for the blade and the engine to stop and remove the key at the main switch

- before you transport the device.
- before you step away from the device, even for just a short time.
- before you clean or check the device or before you carry out work on the device.
- before you unblock or unclog the discharge area.

### Risk of injury due to uncontrolled rolling

Never switch off the device using the main switch. Otherwise, the parking will no longer be activated and the device can roll away.

Only park the device on flat surfaces.

### Risk of burns

Do not touch the muffler, the engine, and the gearbox. These parts become very hot during operation and you can get burned. If a jumpy movement occurs, the risk of additional injuries can result.

### Vibrations

Have an authorised service centre check the device

- when the blade has hit an object.
- if the device starts to vibrate unusually severely.

Unusual vibrations are an indication that

- blades are missing or broken,
- the blade is worn excessively or on one side or
- damage to the engine or cutter deck fastening.

### Explosion hazard

Do not work with the device in potentially explosive atmospheres containing flammable liquids, gases or dust. Sparks can occur during work, which can ignite the dust or vapors.

### Fire hazard

Parts of the device can become extremely hot during operation and this may cause fire.

- Carry a sufficient amount of suitable extinguishing media.
- Observe the device and the moved area even after operation to make sure that no fire breaks out.

To prevent a fire hazard, always keep the following components free of dirt, grass, hay, leaking oil, leaking fuel, grease, etc.:

- engine, ventilation grid
- silencer (manifold, protection, spaces)
- battery, cable connections, electric drive units
- area around the fuel tank
- belt drives



## Safety instructions

Observe the information in the operator's manual of the engine manufacturer.

When fuel leaked or was spilled, there is an increased fire hazard.

- If the slope is too steep, fuel can leak from the carburetor or the tank. This presents a fire hazard!

## Prior to mowing

### Personal protective measures



During mowing, always wear safety shoes with good grip and long trousers. Do not mow with open sandals or while shoeless.



Wear safety gloves to protect yourself against injuries when working on the device.



Noise is causing health problems. Use personal ear protection when you are less than 15 metres from the device to avoid hearing damage.



Wear safety glasses and headgear.

Ask your specialised dealer about suitable protective equipment.

### Preparing the mowing area

Prior to mowing, carefully check the perimeter of the lawn. Remove rocks, pieces of wood, bones, wires, and other objects that could be picked up and thrown out by the device.

Remove live cables from the mowing area. These can be damaged during mowing and cause an electric shock or short circuit.

## Danger area

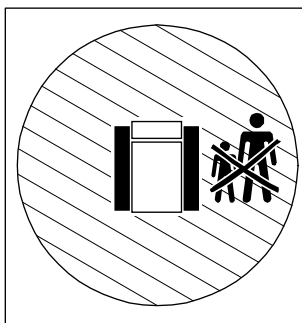

Within the danger area of the device, there is a risk of injury.

The size of the danger zone depends on the conditions of the mowing area.

Stones, trash or other objects on the mowing surface can be caught by the blade and thrown out, causing serious injury. The area in front of the device is especially dangerous. On uneven surfaces, the blade can touch the ground and catch hidden objects.

There is a risk of injury from the rotating blade. Keep your hands and feet away from moving and rotating parts.

During operation, always keep away from the danger zone of the device.

Always disengage the blade before you approach a device that is standing still. Leave the danger zone before you engage the blade.

Dangerous situations can result from unintended steering or driving movements. Persons or obstacles can be hit or run over.

Never drive the device towards yourself.

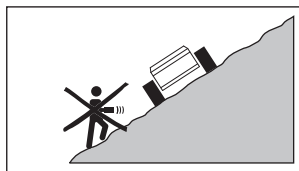

On slopes, the device can topple over and slide towards persons, trap them or rolling them over.

Make sure

- that nobody else besides the user is on the mowing area.
- that nobody is positioned on the slope below the device.

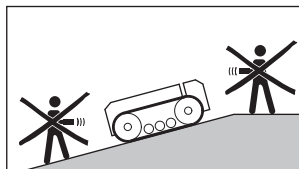

- that you are not in the danger zone.
- that you have a complete overview of the danger area at all times.



Working near the road requires special care.

- Pay attention to traffic when working close to roads. Do not expose yourself to any risk from road traffic.
- Make sure that the road is outside the danger area and that you do not endanger any road users.

There is a risk of property damage in the danger area around the device. Make sure that no vehicles, buildings or other material goods are damaged in the danger area.

### Recommended position for the operator

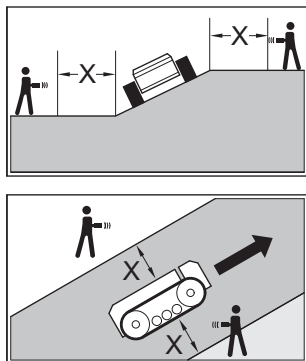

Outside the danger area (X), on the side of the device.

Stop the device when you change your position.

- Choose your position so that you are not in the danger area and you have a full view of the mowing area at all times.

### Danger area for the operator when mowing

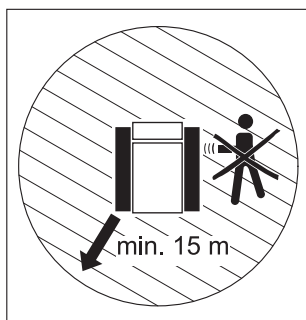

- With a radius of at least 15 meters around the device.

### Danger area for the operator with unclutched blade

- A 5 metre radius around the device.

## Driving on slopes

Observe the notices for the danger area.

If the device, while in use, stops in steep terrain or the engine cuts out, the device can roll away.

- If possible, stop the device crosswise to the slope.
- Never unlock the drive on a slope because the device can roll away.
- Take suitable safety measures to prevent the device from rolling away unintentionally. Secure the device, e.g. with a cable winch or by blocking the chains with a squared lumber.

### Danger due to tipping

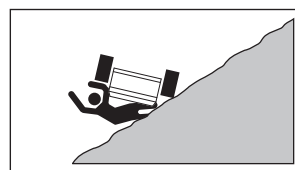

There is a risk of injury on slopes due to tipping or sliding. The device may trap or roll over people. Material goods can be damaged. Never stay below the device when on a slope. Never work when persons, children, or pets are in the danger area.

Safe work in steep terrain is only possible by a trained operator under ideal conditions and adapted driving style.

If the specified maximum slopes can be achieved also depends on the direction of travel, local conditions and other factors.

- Make sure that you know the slope of the hill or that the slope can be determined on site.
- If the ground is uneven, it is not possible to determine the slope without any doubt. The specified maximum slope inclinations can then not be achieved. There is an increased risk of tilting and accidents.
- Unfavorable conditions may reduce the maximum attainable slope, e.g. wetness, loose and slippery ground, dense growth, mowed grass, etc.
- Be extremely cautious when changing the direction.
- Always keep the speed low when moving on slopes.
- Do not start abruptly and do not brake abruptly.
- If the cutting height is set unnecessarily high or the mower is in maintenance position, the centre of gravity of the device increases. As a result, the specified maximum slope gradients cannot be achieved. There is an increased tilting and slipping hazard!

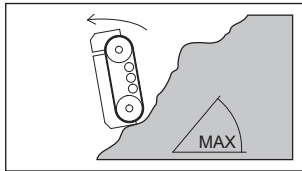

- While driving uphill or downhill, only use the device up to a maximum slope inclination of 44°.

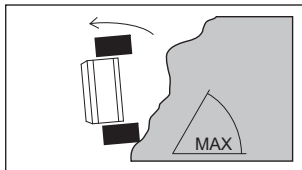

- Only use the device across the slope up to a maximum slope inclination of 55°.
- Do not turn if the slope inclination exceeds 44°.

If the downhill chains get caught in depressions, terrain edges or paths, the device can tip over or slide away.

- Do not drive near dangerous areas (e.g. walls, slopes, steep declines, edges of bodies of water etc.).

When the uphill chains encounter obstacles, the device can tilt or slip.

- Only drive when you know about the terrain conditions and terrain is free of obstacles.
- Watch for hills, dips and other visible hazards such as tree stumps, roots, branches, rocks, etc.

### If the device tilts or slips

- Never try to stop a tilting or sliding device. Severe injuries can result.
- Remove leaking fluids (oil, fuel, battery acid) from the device and the floor. Deposit of contaminated soil environment friendly according to the local regulation.
- Undetectable damage may have occurred to the device. In case of malfunctions, there is a risk of injury. Have an authorised service centre check the device.

### Increased risk of tipping with additional load

Loads or attachments change the centre of gravity of the device and increase the risk of tipping.

Loads and attachments are not permitted.

### Risk of injury due to unauthorised use

Do not leave the Remote Control Transmitter unattended to prevent unauthorised use.

Always press the start-stop-button before putting the Remote Control Transmitter down.

Protect the Remote Control Transmitter against unauthorised access before you leave the device or start maintenance and cleaning work.

Remove the key from the main switch when you are not using the device.

### When work is completed

After each mowing, close the fuel valve and the tank ventilation.

Before you leave the device, wait for the blade and engine to stop and remove the key from the main switch.

After switching it off, let the device cool down for at least 20 minutes before you store it in a dry, closed, sufficiently ventilated room.

Never place the device with fuel in the tank inside a building where petrol vapours may come into contact with open flames or sparks.

### Use caution during maintenance and repair

Only carry out work as described in these operating instructions. Have an authorised service centre perform all other work.

Only use blades and spare parts approved by the manufacturer. Unauthorised blades and spare parts can cause severe injuries.

Prior to all maintenance work, wait until the engine comes to a standstill and pull off the spark plug connector.

We explicitly point out that, in accordance with the Product Liability Act, we are not liable for damages that were caused by our devices if

- worn or damaged parts were not repaired or replaced on time.
- these damages were caused by improper repair.
- when changing a part, our original parts or parts authorised by us were not used.
- the repair work was not carried out by an authorised service centre.

The same applies for spare parts and accessories.

## Device description

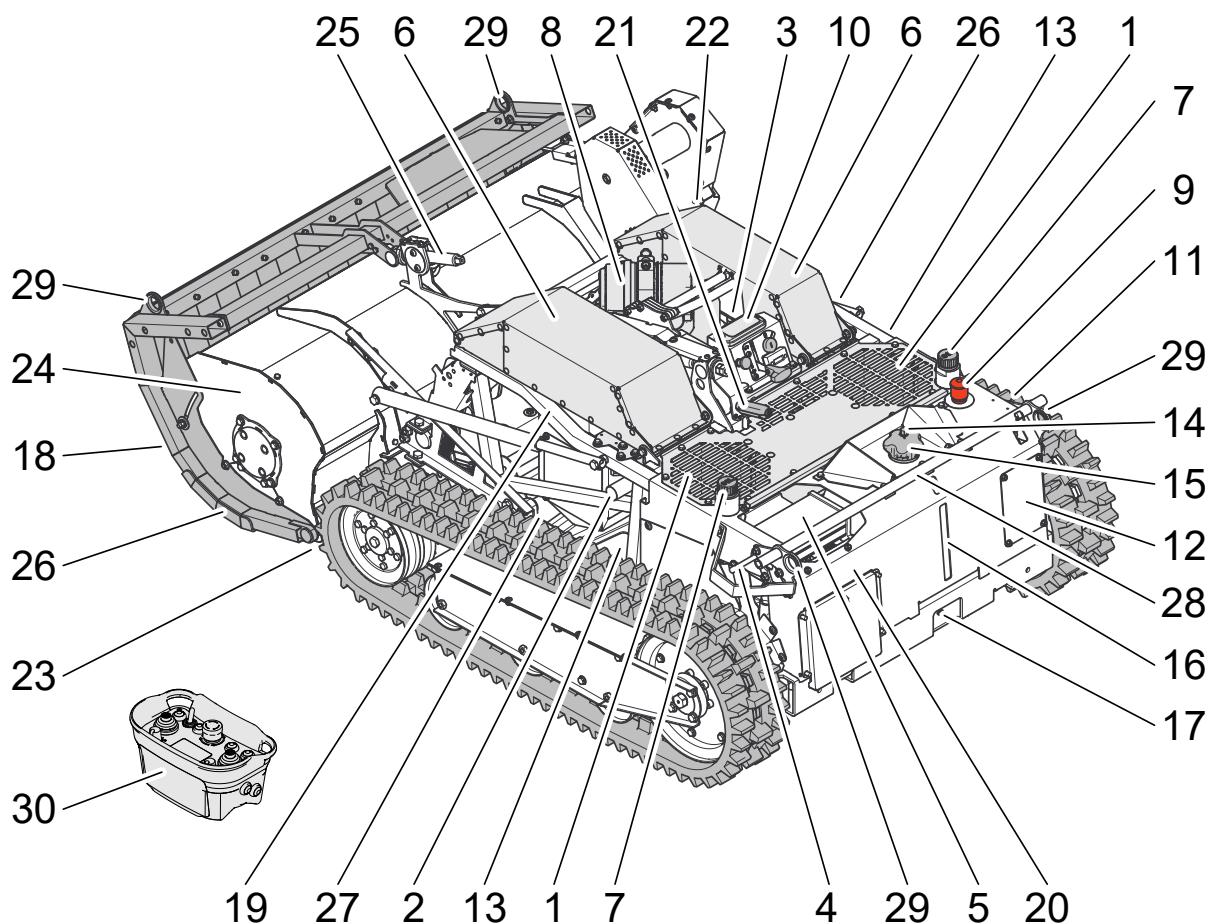

- |  |                                       |
|--|---------------------------------------|
| 1 Gearbox fan  | 20 Type plate                         |
| 2 Silencer   | 21 Cutting height limitation          |
| 3 Oil dipstick / oil filler neck   | 22 Cutting height display             |
| 4 Antenna  | 23 Ejection rubber (bottom of device) |
| 5 Receiver   | 24 Mower cover                        |
| 6 Ventilation grid   | 25 Slider adjustment                  |
| 7 Oil surge tank hydrostat   | 26 Sliders                            |
| 8 Air filter   | 27 Chain tensioner and spring package |
| 9 Emergency stop switch  | 28 Extension chain tensioner          |
| 10 Status indicator  | 29 Eyelets                            |
| 11 Power socket  | 30 Remote Control Transmitter         |
| 12 Cover fuse compartment / fuses (see chapter "Technical specifications") |                                       |
| 13 Unlocking drive   |                                       |
| 14 Tank ventilation  |                                       |
| 15 Tank cap  |                                       |
| 16 Fill level tank   |                                       |
| 17 Fuel valve  |                                       |
| 18 Protective skirt/flaps (front of the device)                            |                                       |
| 19 Tabular frame   |                                       |

## Control elements on the device

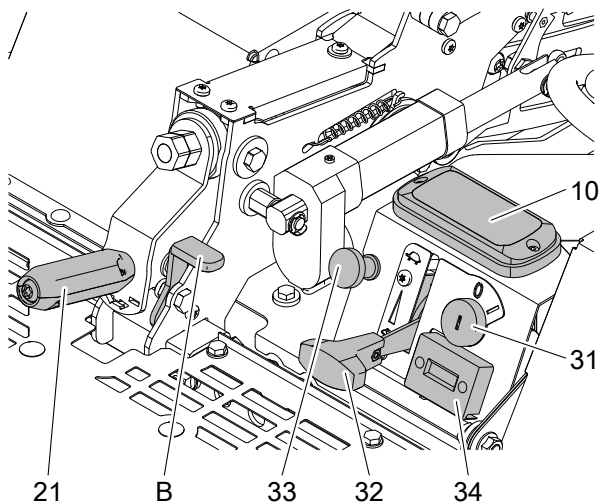

### Main switch (31) with key

You can switch on/off the circuit of the control with the main switch.

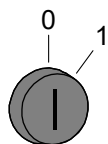

- 0: Off  
The key can be removed.
- 1: On

### Accelerator lever (32)

Using the accelerator lever, you change the engine speed.

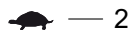

- 1: Highest speed (full throttle)  
Press the accelerator lever all the way down.



- 2: Lowest speed (idle)  
Pull the accelerator lever all the way up.

### Lever for starter flap (choke) (33)

The choke is closed only for start up the cold engine. As soon as the engine is running, open the choke.



Close the choke:  
Pull out the lever for the starter flap (33).



Open the choke:  
Push in the lever for the starter flap (33).

### Operating hours counter (34)

The operating hours are counted as soon as the engine is running.

Display:

- When engine is running: engine speed
- When engine is off: operating hours

### Status light (10)

The status light on the device flashes when the blade is engaged.

### Emergency Stop switch (9)

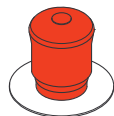

Activate Emergency Stop:  
Press the switch.

Revoke Emergency Stop:  
Turn the switch in the direction of the arrow.

### Fuel valve (17)

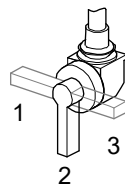

- 1: Reserve
- 2: Open
- 3: Closed

### Cutting height limitation (21)

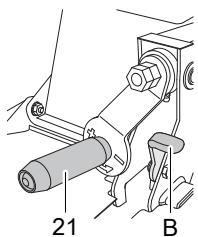

The lowest cutting height can be adjusted continuously. To prevent unintentional adjustment of the crank while working, the cutting height limitation can be fixed.

The top position is the maintenance position. The blade is automatically disengaged.

**Notice:** The cutting height is adjusted during operation using the height adjustment on the Remote Control Transmitter (see chapter “Setting the cutting height”).

#### Setting the lowest cutting height

Swivel the securing bracket (B) up.  
Turn the cutting height limitation (21).

+: Increase the lowest cutting height.

–: Reduce the lowest cutting height.

#### Fixing the lowest cutting height:

Swivel the securing bracket (B) up.

### Cutting height display (22)

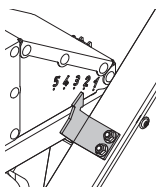

The cutting height can be continuously adjusted from 1 to 5.

The position above 5 is the maintenance position. The blade is automatically disengaged. The maintenance position can only be reached by turning the cutting height adjustment.

### Unlocking drive (13)

To move the device without engine drive, unlock the drive on both sides of the device. This simultaneously releases the parking brake.

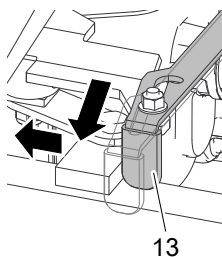

#### Unlocking drive/releasing parking brake:

Pull lever (13) forward and engage.



#### Locking drive/activating parking brake:

Release lever (13) and push it back.

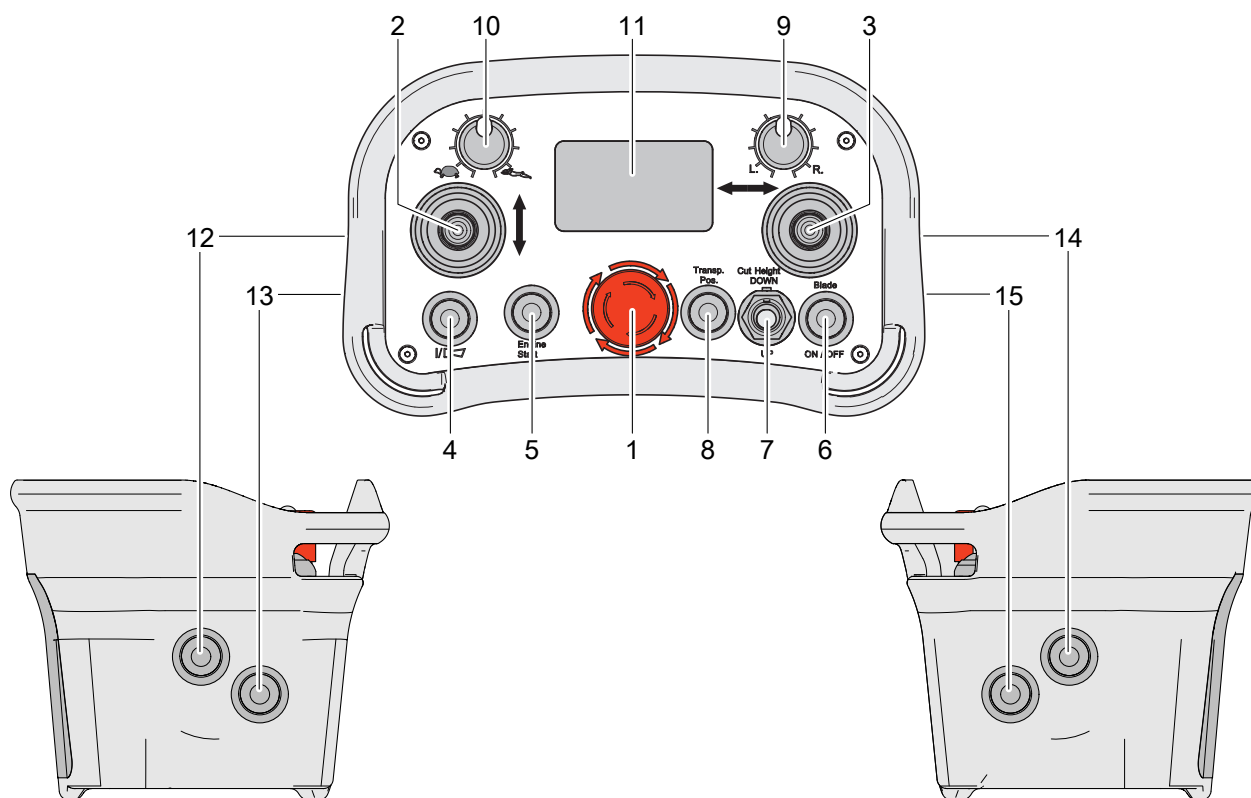
## Control elements on the transmitter





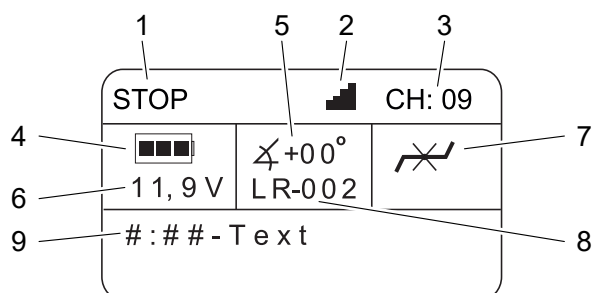

Pos.	Symbol	RC function	Type
1		Remote Control Transmitter: Switch on, switch off	Start-stop switch
2		Forward drive and driving speed	Joystick
		Reverse drive and driving speed	
3		Steering to the left	Joystick
		Steering to the right	
4		Connecting/horn	Button
5	Engine Start	Engine start	Button
6	Blade ON/OFF	Engage/disengage blade	Button
7	Cut Height DOWN	Lower cutting height	Toggle switch
	UP	Higher cutting height	
8	Transp. Pos	Transport position (blade is disengaged).	Button
9	L. R.	Trimming steering	Rotary knob

Pos.	Symbol	RC function	Type
10		Fast maximum driving speed	Rotary knob
		Slow maximum driving speed	
11	-	Display (see chapter "Display on the Remote Control Transmitter")	-
12	-	<ul style="list-style-type: none"> <li>For use with steering assistant X-ACT TRACK (see chapter "Accessories").</li> <li>For calibration purposes by an authorised service centre.</li> </ul>	Button
13	-		Button
14	-		Button
15	-		Button

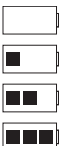
## Display on the Remote Control Transmitter



Pos.	Symbol	Meaning
1	SCAN	<u>Channel search</u> : After switching on, the Remote Control Transmitter establishes a radio connection with the receiver.
	STOP	<u>Remote Control Transmitter not active</u> : After a radio connection is established between the Remote Control Transmitter and receiver, the Remote Control Transmitter switches to inactive mode.
	RUN	<u>Remote Control Transmitter in operation</u> : Operational readiness of the Remote Control Transmitter
	X-ACT	<u>Steering assistant</u> : X-ACT TRACK
2		<u>Signal strength and radio connection</u> : – No bar: No reception. – 4 bars: Full reception.
3	CH: ##	<u>Channel number</u> : Until a radio connection is established, different channel numbers are run through. After radio contact has been established between Remote Control Transmitter and receiver, the channel number is displayed.
4		<u>Battery capacity of the Remote Control Transmitter</u> : – No bar: Battery empty. Change the batteries (see chapter "Checking and changing the battery of the transmitter"). – Three bars: Battery full.
5	 +00°	<u>Inclination</u> : Current inclination of the device in the direction of travel or across the direction of travel. Only the larger angle is displayed.
6	11,9 V	Battery voltage of the device

Pos.	Symbol	Meaning
7		Blade disengaged
		Blade engaged
8	LR-002	<u>Steering trim</u> : Set value of rotary knob "trim steering".
9	#:##	<u>Error code</u> : When the control detects an error, an error code is displayed. To see what this code means, refer to chapter "Error codes".
-		<u>Energy saving mode</u> : If you do not press any buttons over a longer period of time, the Remote Control Transmitter switches off automatically.

## More elements on the Remote Control Transmitter

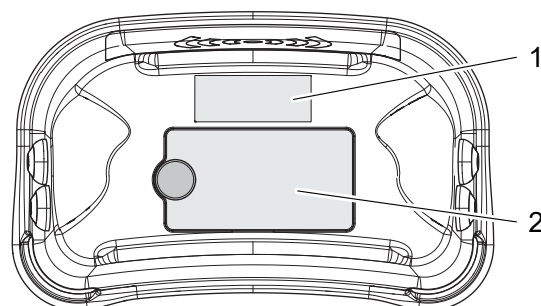

Pos	Designation	Description
1	Type plate	Information about the Remote Control Transmitter – Unit: Type designation of the Remote Control Transmitter – System: Type designation of the combination of Remote Control Transmitter and receiver – Serial no: Serial number of the Remote Control Transmitter – Address: Radio address of the Remote Control Transmitter – Date: Date of manufacture – Country of manufacture
2	Cover of battery compartment	To change the battery (see "Checking and changing the battery of the transmitter").



## Elements on the receiver

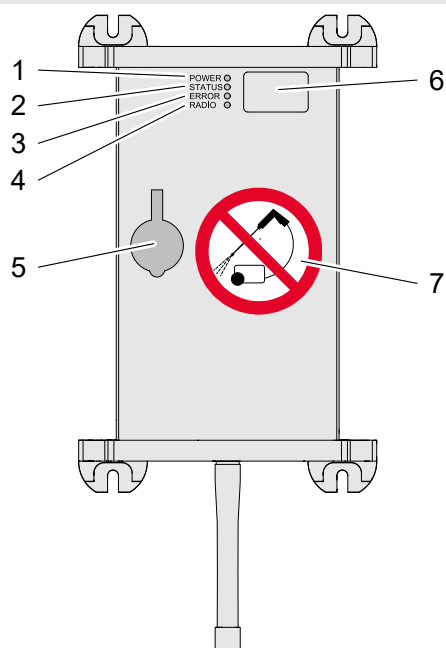

Pos	Designation	Description
1	LED "POWER"	Lights up green: The battery voltage is ok.
2	LED "STATUS"	Glowing yellow: Receiver and Remote Control Transmitter connected.
3	LED "ERROR"	Glowing red: Error, Emergency Stop
4	LED "RADIO"	Flashing green irregularly: Radio connection not optimal Lights up green: Optimal radio connection.
5	USB port	Only for authorised service centre
6	Type plate	Information about the receiver: – Product name of the receiver – Unit: Type designation of the receiver – System: Type designation of the combination of Remote Control Transmitter and receiver – Serial no: Serial number of the receiver – Address: Radio address of the receiver – Date: Date of manufacture – Country of manufacture
7	Prohibition sign	Do not clean the device with water spray or a high-pressure cleaner!

## Optical signals

### Status indicators on the device

- Flashing: Beware, blade is engaged.

## Acoustic signals

### Signals of the device

- Single honk signal after the Remote Control Transmitter is switched on: Radio contact between Remote Control Transmitter and receiver was successfully established.
- Horn sounds at intervals: Receiver is in operation. Radio contact to Remote Control Transmitter interrupted. Warning of battery consumption.

## Safety functions

To ensure safe operation at all times, the device is equipped with safety functions. To make the engine and the blade run, certain requirements need to be fulfilled. These requirements are described in the corresponding chapters.

The device is equipped with an Emergency Stop. To avoid danger, use the Emergency Stop to switch off all functions of the device. The device is immediately put into a safe state (see chapter "Emergency stop").

## Information on mowing

Prior to mowing, check the device for completeness, proper function, and cleanliness. A dirty ventilation grid causes overheating of the engine which can result in engine damage. There is a risk of fire due to dirt on the muffler.

Frequent engagement and disengagement of the clutch increases wear of the blade drive belt and the blade brake. Especially in case of high grass, clutch engagement leads to overload.

To keep the area well maintained, mow frequently and keep the grass short.

Only mow with a sharp and undamaged blade. Check blade and flail shaft (see chapter "Maintenance"). Contact an authorised service centre if you find faults or damage during the test.

Do not mow when the grass is wet or when it is raining. The turf may be damaged and there is a danger of slipping!

Turn the device around only in already mowed sections.

Do not leave the device unattended while the blade engine are running.

Set the cutting height so that the blade edges do not touch the ground in case of uneven terrain. To do this, use the cutting height limiter and the adjustment of the sliders.

For mowing, always turn the accelerator lever to full throttle to achieve the best mowing performance.

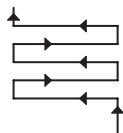

To avoid blockage during the ejection of grass, we recommend, for flat terrain, to proceed according to the mowing patterns. Mulch is shredded into much smaller pieces when you mow the terrain once again in the opposite direction.

Observe the notices for the danger area.

Stop the device when you change your position.

- Choose your position so that you are not in the danger area and you have a full view of the mowing area at all times.

## Prior to starting

### Checking the oil level

#### Notice

Incorrect oil level can damage the engine.

- Prior to each use, check the engine oil level.

Observe the information in the operator's manual of the engine manufacturer.

### Fuel

For fuel, use lead-free gas (see operating instructions of the engine manufacturer).

You can use E10 fuel. Do not store E10 fuel longer than 30 days.

Do not use E85 fuel. The fuel must contain less than 10 % ethanol.

### Tanking up

#### ⚠ Warning

Fuel is ignited by hot engine parts.

- Prior to filling up, switch off the engine and wait for at least 20 minutes until the engine has cooled down. Observe the safety instructions regarding the fuel!

### Filling up with fuel

1. For filling, use a canister with filler spout or a funnel.
2. Open the canister carefully so that existing excess pressure is slowly reduced.
3. Open the tank cap carefully so that existing excess pressure is slowly reduced and no fuel sprays out.
4. Fill the fuel tank.
5. Tightly close the tank cap again.

## Carrying the Remote Control Transmitter

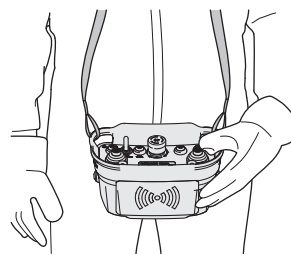

Attach the belt to the Remote Control Transmitter.

Carry the Radio Remote Transmitter as shown. Adjust the length of the belt so that you can easily reach the controls and operate them safely at all times.

## Checking and changing the battery of the transmitter

When working, always carry an extra battery.

Consequences of too weak or unsuitable batteries in the transmitter are:

- The range of the radio contact drops.
- The radio contact becomes unreliable.
- An Emergency stop is triggered.

The transmitter can be operated with commercially available rechargeable batteries. Only use high-quality and charged rechargeable batteries to avoid functional problems.

### Checking the battery

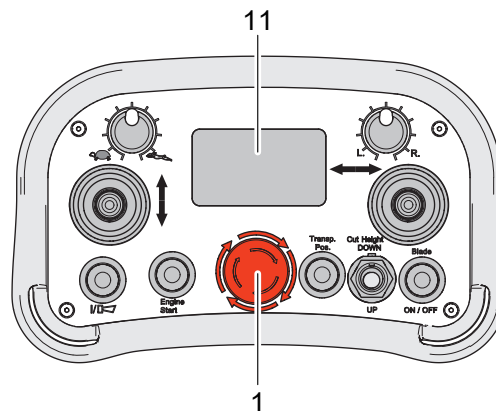

1. Turn the start-stop switch (1) clockwise to switch on the Remote Control Transmitter.

- ⇒ In the display (11) the channel number is displayed.
- ⇒ In the display (11) the battery capacity is displayed.

**Notice:** If the batteries are unsuitable or faulty, this test can produce an incorrect result. In that case, please replace the batteries.

### Changing the batteries

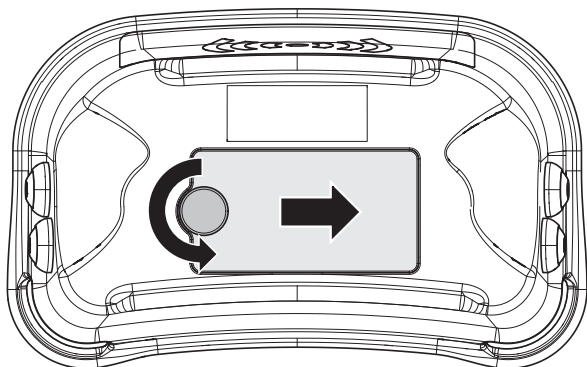

1. Move the device to a safe position and switch it off.
2. Loosen the locking screw on the battery compartment and remove the cover.
3. Replace the batteries with 2 new batteries or 2 charged batteries.
4. Close the cover and tighten the locking screw.
5. Switch on the Remote Control Transmitter via the start-stop switch.
6. Check the battery capacity on the display.

### Adjusting the sliders

#### ⚠ Warning

Risk of injury due to rotating blade.

- Engage the blade and switch off the engine before you adjust the sliders.

#### ⚠ Warning

Risk of injury caused by ejected objects.

- Adjust the sliders so that the blade does not touch the ground even on uneven terrain.

By adjusting the sliders, the minimum distance between the blade and the ground is set. Depending on the nature of the terrain, you can prevent parts of the mowing area or objects from being caught by the blade.

The adjustment of the sliders is stepless.

**Notice:** A setting that is too low can lead to increased wear of the blades.

1. Switch off the blade and wait until the blade stops.

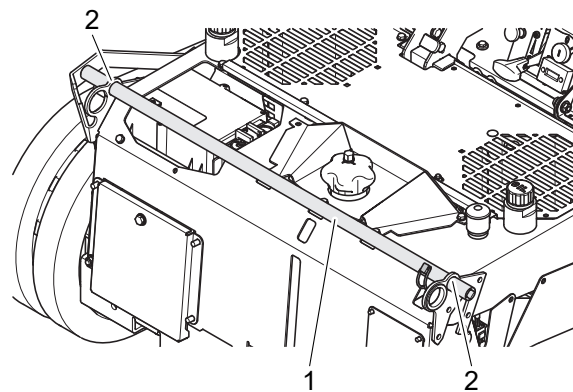

2. Loosen the securing splint and remove the extension (1) from the holder (2).

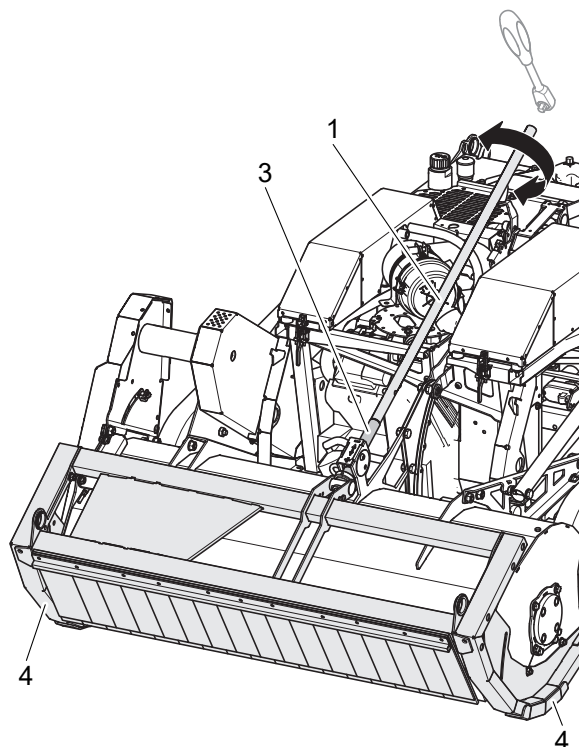

3. Place the extension (1) on the square (3) of the spindle.
4. Put a socket wrench handle 1/2" on the extension (1) and turn the square (3) until the skid (4) has reached the desired distance.
  - ⇒ Spindle on the square (3) moves in direction +: increases the distance to the cutting tool.
  - ⇒ Spindle on the square (3) moves in direction -: reduces the distance to the cutting tool.
5. Put the extension (1) back into the holder (2) and fasten it with the securing splint pin.

## Setting the cutting height limitation

### ⚠ Warning

Risk of injury due to rotating blade.

- Disengage the blade before you approach the device.

### ⚠ Warning

Risk of injury caused by ejected objects.

- Adjust the lowest cutting height so that the blade does not touch the ground even on uneven terrain.

The adjustment of the cutting height limitation is stepless.

If the cutting height is set too high, objects can be ejected. In addition, the cutting pattern may be worse.

The top position is the maintenance position. In maintenance position, the blade is automatically disengaged and cannot be engaged.

## Setting the lowest cutting height

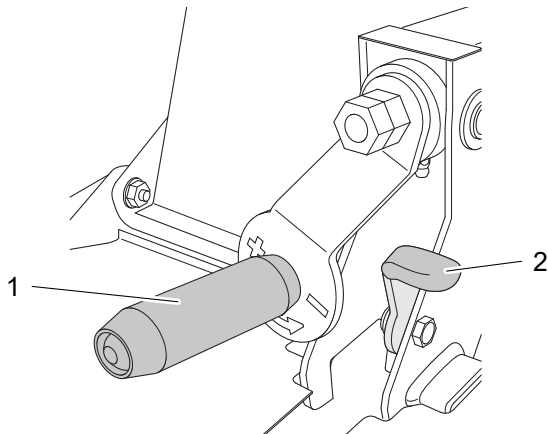

1. Switch off the blade and wait until the blade stops.
2. Stand behind the device.
3. Swivel the securing bracket (2) upwards.
4. Turn the crank (1) until the desired lowest cutting height is reached.
  - ⇒ Turning in direction +: Increase the lowest cutting height.
  - ⇒ Turning in direction -: Reduce the lowest cutting height.
5. Swivel the securing bracket (2) downwards to prevent unintentional adjustment of the crank while working.
6. Leave the danger zone before you engage the blade.

## Switching on receiver and transmitter

### ⚠ Warning

Risk of injury due to unexpected movement when switching on and starting.

- Make sure that no persons, children, animals or objects are in the danger area.
- Keep your hands and feet away from the rotating parts.
- Leave the danger zone before you switch on the Remote Control Transmitter or start the engine.

1. Insert the key into the main switch of the device.
2. Turn the key to pos. I.

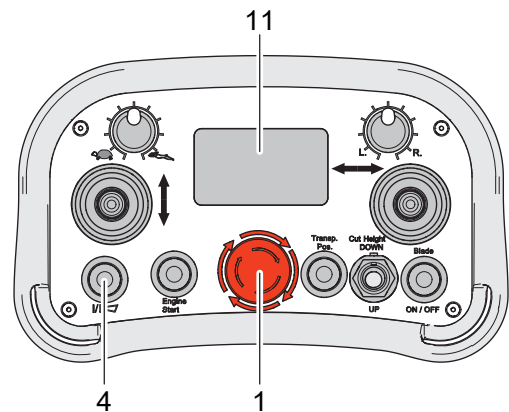

3. Turn the start-stop switch (1) clockwise to switch on the Remote Control Transmitter.
  - ⇒ In the display (11) the mode "SCAN" is displayed.
4. Wait until the horn of the device sounds once.
  - ⇒ In the display (11) the channel number is displayed.
  - ⇒ In the display (11), the mode "STOP" is displayed.
5. Press the button "Connect/horn" (4) on the Remote Control Transmitter to switch the device ready for operation.
  - ⇒ The horn signals that the device is ready for operation.
  - ⇒ In the display (11) the mode "RUN" is displayed.

## Selecting the radio channel

When you switch on the Remote Control Transmitter, the receiver automatically searches for a suitable radio channel.

If several remote controlled devices are operated at the same time or when another Remote Control Transmitter is located close by, faults in the radio contact can occur. Then change the radio channel.

### Switch the radio channel

1. Press the start-stop-button on the Remote Control Transmitter and switch off the device using the main switch. Wait 5 seconds.
2. Switch the receiver and the Remote Control Transmitter on again (see chapter "Switching on receiver and transmitter").

## Training operation

### ⚠ Warning

Risk of injury due to rotating blade.

- Make sure that no persons, children, animals or objects are in the danger area.

### ⚠ Warning

Risk of injury caused by ejected objects.

- Never mow when persons, children, pets or material assets are in the danger area.

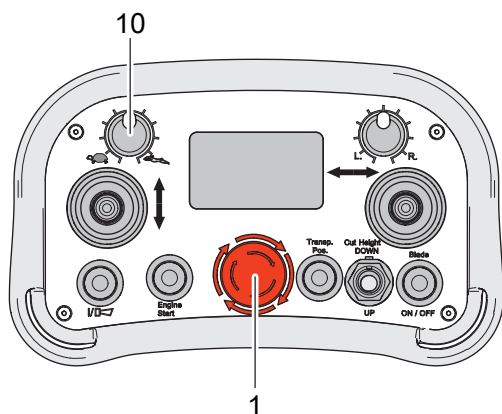

Make sure that you know at all times how to stop the device:

- Press the start-stop switch (1) on the transmitter.

Limit the maximum travel speed using the rotary knob (10) on the transmitter.

First practice driving and steering with the blade switched off on a large, open and level area.

Practice driving around obstacles.

Never steer the device towards yourself.

Mow on a level and clear area first, slowly increase the difficulty (uneven terrain, obstacles, slight slopes).

Move on to difficult terrain and slopes only after you have safely mastered the device.

## Operating

### Starting the engine

#### Requirements

- The fuel valve is open.
- The tank ventilation is open.
- Receiver and transmitter are switched on and ready for operation.

#### Starting

### ⚠ Danger

Danger of poisoning due to poisonous exhaust gases.

- Do not operate the engine in closed or insufficiently ventilated rooms.
- Please observe the safety instructions regarding the poisoning risk.

### ⚠ Warning

Risk of injury due to unexpected movement when switching on and starting.

- Make sure that no persons, children, animals or objects are in the danger area.
- Immediately press the start-stop-button on the Remote Control Transmitter and the Emergency Stop switch on the device when an unexpected movement occurs.
- Make sure that no further hazards result from an unexpected movement.

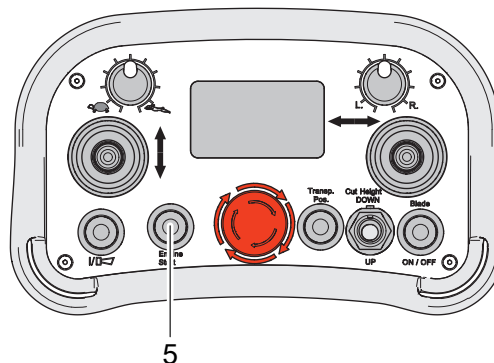

#### 1. Cold start:

Move the accelerator lever to middle position. Close the choke.

#### When engine is warm:

Move the accelerator lever to middle position. Do not use the choke.

#### 2. Press the “Engine start” button (5) on the transmitter.

⇒ Engine is started.

#### 3. Only after cold start:

Open the starter flap (choke).

#### 4. For mowing, set the accelerator lever to the maximum speed.

## Steering and driving

### ⚠ Warning

Risk of injury caused by the moving device.

- ▶ Make sure no other persons stand in front of or behind the device and that your path is clear of obstacles.
- ▶ Make sure that no other persons, children or animals are transported.
- ▶ Do not ride on the device yourself.
- ▶ Never drive the device towards yourself.
- ▶ Make sure that you are outside the danger zone.

### ⚠ Warning

Driving on slopes is dangerous. There is a tilting and slipping hazard.

- ▶ Observe the safety instructions regarding "Driving on slopes" and "Danger area".

### Notice

Steering while stationary or turning on the spot can damage the ground.

- ▶ Only steer or turn when stationary if the ground is not damaged.
- ▶ Note that steering while stationary on a surface with good grip (e.g. concrete or asphalt) can lead to increased wear of chains.

## Steering

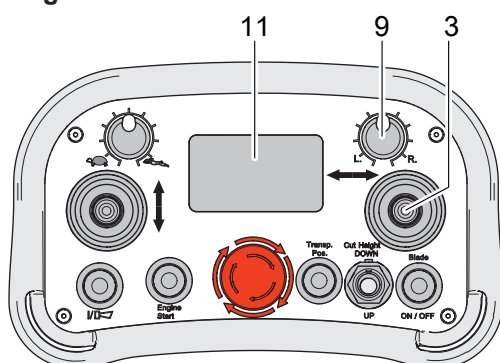

Steer the device with the right joystick (3) to the left or to the right.

The more you push the joystick, the more the device steers.

**Notice:** excessive steering movements reduce traction. The device can stop or damage the ground.

## Turning (steering while stationary)

The device can be turned on the spot. The device rotates around its own axis.

The more you push the joystick, the faster the device rotates.

When you release the joystick, the rotation will stop.

When turning the device, make sure that the device always moves away from you.

## Steering while driving

The device drives a curve.

The further you push the joystick, the tighter the curve becomes.

When you release the joystick, the device steers straight forward.

## Trimming steering

If the device does not drive straight in spite of the middle position of the steering wheel, compensate this with the rotary knob "Trimming steering" (9).

The value of the steering trim is shown on the display (11).

- The values are between  $-127$  (maximum steering trim to the left) and  $127$  (maximum steering trim to the right).
- The value  $000$  corresponds to the middle position (no steering trim).

R. If the device moves to the left:  
Turn the rotary knob "Steering trim" (9) to the right until the device drives straight ahead.

L. If the device moves to the right:  
Turn the rotary knob "Steering trim" (9) to the left until the device drives straight ahead.

## Driving

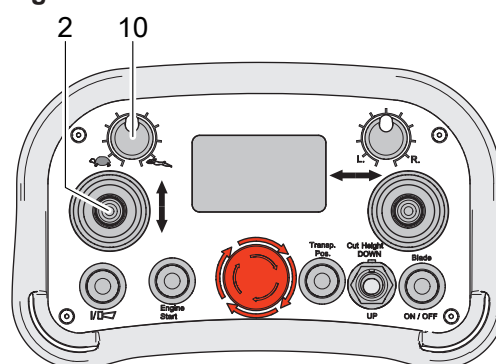

Adjust the speed and the direction of travel with the left joystick (2).

The more you push the joystick, the faster the device moves.



## Operating



Moving forward: Pressing joystick forward

Stopping (neutral position/parking brake):  
Releasing the joystick



Moving in reverse: Pressing joystick backward

Always reverse slowly. Be especially cautious when the blade is engaged.

### Limiting the speed



Fast maximum driving speed



Slow maximum driving speed

Limit the driving speed with the rotary knob (10) to a speed at which you can control the device reliably. Maximum speed is reached when you push the joystick all the way.

**Notice:** Adapting the driving speed to the mowing conditions enables:

- Clog-free mowing.
- Comfortable holding of the joystick at the stop.
- The device rotates more slowly around its own axis when turning.

### Driving on steep terrain

#### ⚠ Warning

Driving on slopes is dangerous. There is a tilting and slipping hazard.

- ▶ Have a qualified technician show you how to use the machine safely before mowing on steep terrain.
- ▶ Observe the safety instructions regarding “Driving on slopes” and “Danger area”.

#### Notice

Especially on steep terrain, the engine can be damaged if the oil level is too low.

- ▶ Prior to each use, check the engine oil level (“Maintenance”).

Preferably drive crosswise on the slope. This reduces the risk of tipping and improves the traction of the chains.

**Notice:** Excessive steering movements on steep terrain reduce traction. The device may stop or damage the ground.

## Setting the cutting height

#### ⚠ Warning

Risk of injury caused by ejected objects.

- ▶ Adjust the cutting height so that the blade does not touch the ground even on uneven terrain.

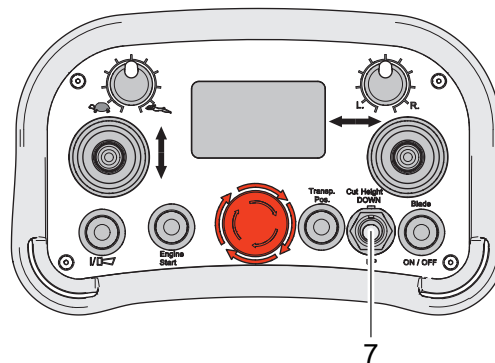

Continuously adjust the cutting height with the toggle switch (7) from the lowest cutting height up to max. 5. The lowest cutting height that can be achieved depends on the cutting height limitation (see chapter “Setting the cutting height limitation”).

**Notice:** If the cutting height is set too high, objects can be ejected. In addition, the cutting pattern may be worse.

Cut Height

- UP      Increasing cutting height: Continue to press the toggle switch (7) in direction “UP” until the desired cutting height is reached.
- DOWN      Reducing cutting height: Continue to press the toggle switch (7) in direction “DOWN” until the desired cutting height is reached.

### Engaging blade

#### ⚠ Warning

Risk of injury due to rotating blade.

- ▶ Make sure that no persons, children, animals or objects are in the danger area.
- ▶ Make sure that you are outside the danger zone.

#### ⚠ Warning

Risk of injury caused by ejected objects.

- ▶ Never mow when persons, children, pets or objects are in the danger area.
- ▶ Make sure that you are outside the danger zone.

Only engage the blade when it can rotate freely and does not touch objects or the ground.

Do not engage the blade in uncut grass because the blade drive is overloaded, can be damaged or wears prematurely.



## Requirements

- The engine is running.
- The blade is not in maintenance position.

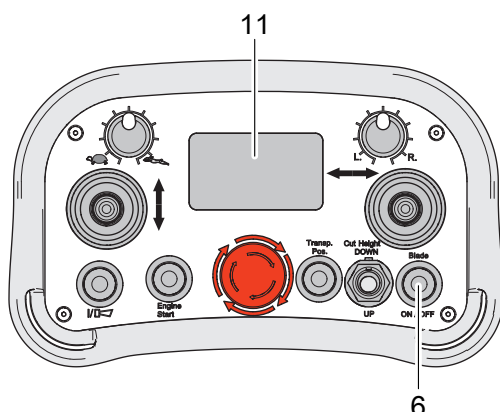

## Engaging blade:

1. Set the highest cutting height.
2. Press the button (6) to engage the blade.
  - ⇒ The blade is engaged.
  - ⇒ The status indicator on the device flashes.
  - ⇒ In the display (11) the symbol "Blade engaged" is displayed.
3. Set the desired cutting height.

## Disengaging the blade:

1. Press the button (6) to disengage the blade.
  - ⇒ The blade is disengaged.
  - ⇒ The status indicator does not flash any longer.
  - ⇒ In the display (11) the symbol "Blade disengaged" is displayed.

## Moving blade to transport position

The blade can be moved from any cutting height into transport position. Use the transport position if the device is only to be moved, e.g. to drive over paths or to get the device out of a dangerous situation.

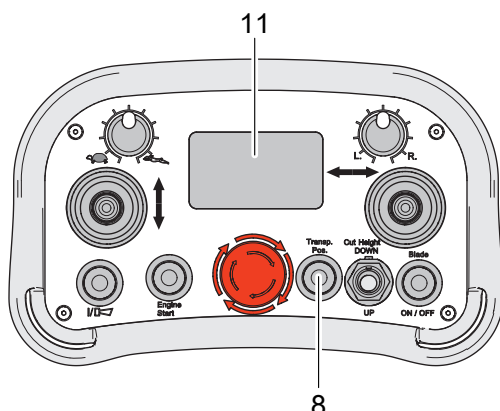

1. Briefly press the button (8) to move the blade to transport position.
  - ⇒ The blade is immediately disengaged.
  - ⇒ The blade is moved to transport position.
  - ⇒ The status indicator does not flash any longer.
  - ⇒ In the display (11) the symbol "Blade disengaged" is displayed.

## Switching off and parking

### ⚠ Warning

There is a risk of injury in case of unauthorised use.

- ▶ Press the start-stop switch on the transmitter.
- ▶ Remove the key on the main switch when you are not using the device.

### ⚠ Warning

Risk of injury due to device that is no longer controllable.

If you switch off the main switch on the device first, the receiver is no longer active. The parking brake is not activated and the device can roll away.

- ▶ Always switch off the device in the order described in the following section.

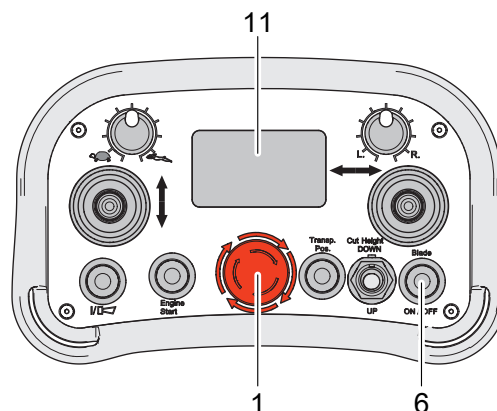

1. Release both joysticks.
2. Press the button (6) to disengage the blade.
  - ⇒ In the display (11) the symbol "Blade disengaged" is displayed.
3. Press the start-stop switch (1) on the transmitter.
  - ⇒ The engine is switched off.
  - ⇒ The travel drive goes to zero position.
  - ⇒ After 10 seconds, the horn sounds with interval.
4. Switch off the device using the main switch.
  - ⇒ The sounding of the horn in intervals is finished.
  - ⇒ The receiver is now de-energized.
5. Remove the key from the main switch.
6. Close the fuel valve and the tank ventilation.

**Notice:** If you do not switch off the main switch at the device, the receiver continues to consume power. After 10 seconds, the horn sounds with interval. Switch off to the main switch so that the battery is not discharged.

### Emergency stop

The device is equipped with an Emergency Stop function. To avert danger, the Emergency Stop function immediately puts the device into a safe state.

The Emergency Stop function can be triggered manually by the user or automatically by the device control.

#### Emergency Stop function on the Remote Control Transmitter

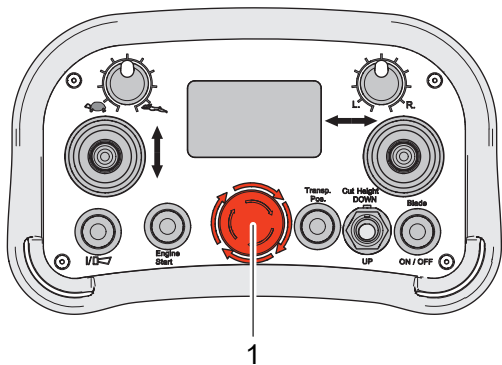

Immediately press the start-stop-button (1) on the Remote Control Transmitter,

- In case of an emergency or a hazardous situation.
- If the device does not work properly.
- To switch off the Remote Control Transmitter.

#### Emergency Stop switch on the device

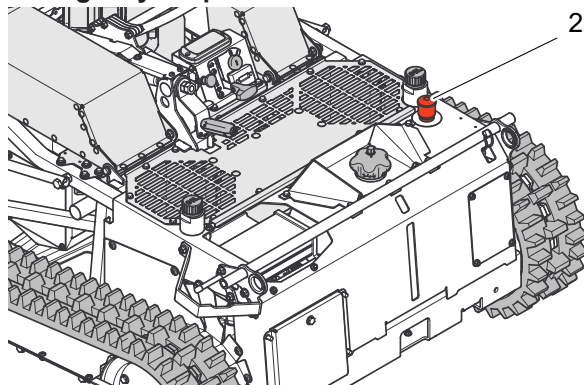

If the device cannot be switched off on the Remote Control Transmitter or the Emergency Stop function of the Remote Control Transmitter has no effect, press the Emergency Stop switch (2) on the device.

Please observe the notices on the danger zone. Approach the device only from the rear.

Do not use the Emergency Stop switch for normal device shut down.

#### Causes of automatic Emergency stop

- Loss of radio contact between Remote Control Transmitter and receiver.
- Malfunction of the control or the device.
- The device has tipped.

**Notice:** When the control detects an error, an error code is displayed. To see what this code means, refer to chapter “Error codes”.

### Consequences of an Emergency Stop

The device is brought to a safe position.

- The blade is disengaged.
- The engine is switched off.
- The travel drive goes to zero position.
- The parking brake is activated.
- The control function of the transmitter is switched off.

### Procedure after an Emergency stop

#### ⚠ Warning

Risk of injury due to unexpected movement when switching on and starting.

- ▶ Make sure that no persons, children, animals or objects are in the danger area.
- ▶ Immediately press the start-stop-button on the Remote Control Transmitter and the Emergency Stop switch on the device when an unexpected movement occurs.
- ▶ Make sure that no further hazards result from an unexpected movement.

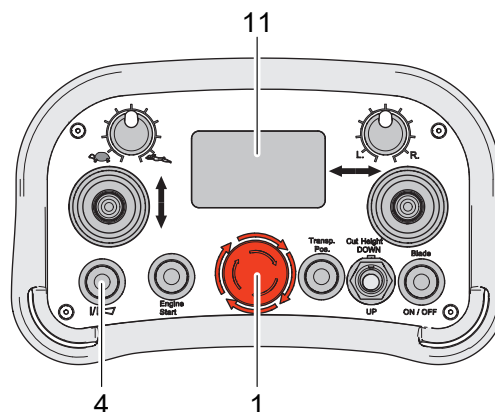

After an Emergency Stop, the following starting procedure must be carried out.

1. Switch off the device using the main switch.
2. Check and eliminate the cause for the Emergency stop. If necessary, observe on the display (11) the shown error codes (see chapter “Error codes”).
3. Switch off the transmitter by pressing the start-stop switch (1) and wait 5 seconds.
4. If necessary, turn the Emergency Stop switch on the device clockwise.
5. Switch on the device using the main switch.
6. Turn the start-stop switch (1) clockwise to switch on the transmitter.
  - ⇒ In the display (11) the mode “SCAN” is displayed.
7. Wait until the horn of the device sounds once.
  - ⇒ In the display (11) the channel number is displayed.
  - ⇒ In the display (11), the mode “STOP” is displayed.
8. Press the button “Connect/horn” (4) to switch the device ready for operation.
  - ⇒ The horn signals that the device is ready for operation.
  - ⇒ In the display (11) the mode “RUN” is displayed.

## Transport

Transport the device on a freight vehicle or a trailer which is designed for a carrying capacity of at least as great as the empty weight of the device.

### Transport on pallets

For transport over short distances, use a fork lift or a lift truck.

For longer distances, load the device with a fork lift onto a freight vehicle or trailer.

The user must be authorised to operate a fork lift. When the machine is lifted, all persons must step away from the working area of the fork lift.

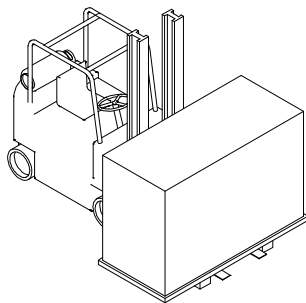

**Notice!** Drive the fork lift completely under the longitudinal beams of the wooden pallets.

### Transport of ready-to-use device

#### ⚠ Warning

Risk of injury due to the heavy weight of the device. The device can fall over and fall down and cause severe injuries.

► Observe the following notices.

Do not stay in the tilting area of the device.

Prior to each transport, let the device cool down for at least 20 minutes. Close the fuel valve and the tank ventilation.

#### Loading

Use suitable ramps for loading that

- can carry the empty weight of the device + 200 kg.
- are wider than the device.
- have a slip-free surface.

#### Notice

Risk of damage due to incorrect fastening of straps.

- Fasten the straps only at the points shown in the figure.
- Do not overtighten the straps.

1. Put the device in front of the ramps and make sure that the ramps
  - are as wide as the wheel gauge of the device.
  - are tightly secured to the platform.
  - are not steeper than 15°.
2. Carefully drive the device via the ramps onto the platform.
3. Observe the instructions in chapter “Switching off and parking”.
4. Secure the device against rolling, sliding and tilting. Use straps that support the weight of the device.
5. Set the mower to the lowest cutting height so that the cutting height limitation touches the ground.
6. Fasten the device to eyebolts and frame parts with straps that can hold the weight.

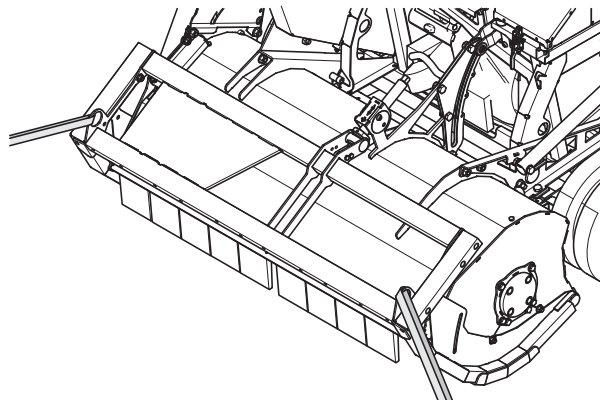
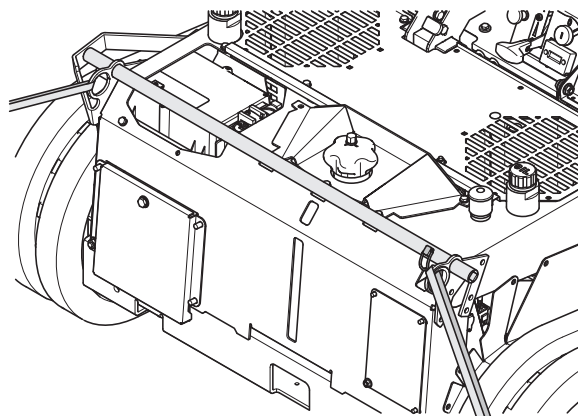

#### Unloading the device

1. Slacken the transport attachments.
2. Carefully drive the device over the ramps off the loading area.

Observe the information in chapter “Loading”.

## Moving the device without drive

### ⚠ Warning

With the drive unlocked, the device can roll away.

- ▶ Never unlock the drive in steep terrain without securing the device against rolling away.

If the engine or the drive do not work any longer, the device can be towed.

1. Secure the device against rolling or sliding.
2. Use a suitable towing device (e.g. cable winch) that can hold the weight of the device.
3. Only attach the towing device to the lashing eyes or to frame parts of the device that can hold the weight of the device.
4. For towing, unlock the drive. This simultaneously releases the parking brake.

## Disconnecting the drive

### ⚠ Caution

Risk of injury due to hot silencer.

- ▶ Do not touch the silencer when unlocking the drive. The silencer becomes very hot during operation and you can get burned.

### Notice

When the engine is started while the drive is unlocked, the hydraulic drive can be destroyed.

- ▶ Never start the engine when the drive is unlocked.

To move the mower without engine drive, unlock the drive on both sides of the device.

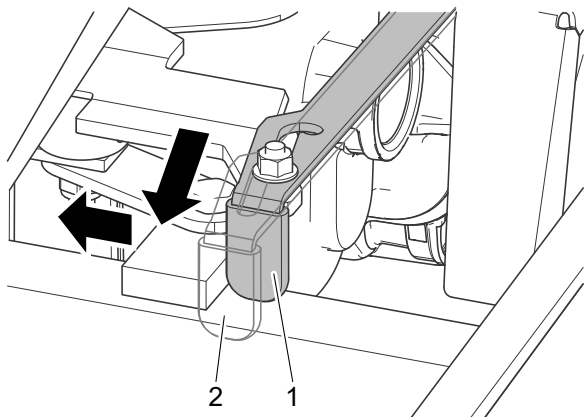

1: = Locked

2: = Unlocked

## Maintenance

### ⚠ Danger

Danger of poisoning due to poisonous exhaust gases.

- ▶ Do not operate the engine in closed or insufficiently ventilated rooms.
- ▶ Please observe the safety instructions regarding the poisoning risk.

### ⚠ Warning

Burn hazard from hot surfaces.

- ▶ Switch off the engine.
- ▶ Let the device cool down for at least 20 minutes before you start any maintenance and cleaning work.

### ⚠ Warning

Risk of injury caused by unexpected movement. When tests are carried out, the device can move unexpectedly.

- ▶ Make sure that no persons, children, animals or objects are in the danger area.
- ▶ Immediately press the start-stop-button on the Remote Control Transmitter and the Emergency Stop switch on the device when an unexpected movement occurs.
- ▶ Make sure that no further hazards result from an unexpected movement.

### ⚠ Warning

Risk of injury during maintenance and cleaning work when the engine is running.

- ▶ Perform maintenance tasks only then with a running engine if this is required in the Maintenance table.

Prior to all maintenance and cleaning work when the engine is not running:

1. Let the device cool down for at least 20 minutes.
2. Close the fuel valve and the tank ventilation.
3. Press the start-stop switch on the transmitter.
4. Switch off the device using the main switch.
5. Pull off the ignition key.

Improper maintenance can make the device unsafe for operation and result in accidents. Regular maintenance keeps your device ready for use.

Service the device according to the following maintenance instructions.

Contact an authorised service centre if problems during maintenance occur or if you determine deficiencies during one of the following inspections.

## Maintenance overview

For maintenance and cleaning work, always wear safety gloves and safety glasses.

Component	Action	Maintenance interval	
		A	B
Device	Clean.	■	
	Carrying out basic inspection.	■	▲
Mower	Clean (see chapter “Cleaning the mower unit”).	■	
Flammable material	Remove easily flammable debris buildup from the engine and the device.	■	▲
Chassis and impact protection	Check for rust and fissures and check the welding seams.	■	▲
	Are all protective devices and covers in place, fastened correctly and properly functioning?	■	▲
Label	Check the condition of the labels and replace if necessary.	■	▲
Fuel	Check fuel level.	■	
	Is the tank cap closed?	■	
Tank, fuel valve, and fuel line	Check parts for leaks and check for good condition.	■	▲
Ventilation grid	Clean.	■	▲
Engine cooling	Clean.		▲
V-belt and belt covers	Are the belts tensioned correctly, without fissures, and in good condition?		▲
	Clean (e.g. grass remains, dirt)		▲
Bowden cables	Check for proper function and ease of movement.	■	▲
Acceleration lever	Check for proper function.	□	▲
Receiver and Remote Control Transmitter	Check.		▲
Main switch	Check.	■	▲
Safety function	Check start-stop-switch.	□	▲
	Checking the Emergency stop switch.	□	▲
	Check maintenance and cleaning position of the blade.	□	▲
	Checking the automatic blade switchoff. Does the blades switch off automatically if, for 2 minutes, no control on the Remote Control Transmitter is operated?	□	▲
RC functions	Check the drive. Does the device stop when the left joystick is in middle position (parking brake)?	□	▲
	Check steering while standing.	□	▲
	Check the steering trim.	□	▲
	Check steering while driving.	□	▲
	Check cutting height and blade clutch.	□	▲
	Check transport position.	□	▲
Parking brake	Check.	■	▲
Blade and fastening components	Check for wear and damage (see chapter “Checking the blade and flail shaft”).	■	▲
	Change.		▲
	Clean the screw-on point of the knife blade.	■	

## Maintenance

Blade brake clutch	Does the blade function safely and does the blade stop in 7 seconds?	□	▲
Chains	Check for wear.	■	▲
	Check the tension.	■	▲
Engine	Binding information (see operating instructions of the engine manufacturer).	■	▲
	Check the oil level (see operating instructions of the engine manufacturer).	■	▲
	Oil change (see operating instructions of the engine manufacturer).		▲
	Oil filter change (see operating instructions of the engine manufacturer).		▲
Air filter	Maintain.	■	■▲
Spark plug	Check/replace (see operating instruction of engine manufacturer).		▲
Bevel gear	Check the oil level.		▲
Battery of the device	Check the charging conditions.		▲
Hydrostatic transmission	Check oil level.		▲
	Check for leaks.	■	▲
	Oil change after 50-100 h and every 200 h thereafter.		▲
Lubrication	See chapter "Grease lubrication".	■	▲■

A Before and after each use.

B Once a year or every 50 h.

■ By the operator when the engine is not running.

□ By the operator when the engine is running.

▲ By the authorised service centre.



## Maintenance and cleaning position

### ⚠ Warning

Risk of injury due to the heavy weight of the device. The device can fall over and fall down and cause severe injuries.

► Observe the following notices.

To perform maintenance, repair or cleaning tasks at the bottom of the device, you can lift or tilt the device.

- Lift the device only when on level and firm terrain.
- Use only lifting gear or ramps that are suitable for the weight of the device.
- Attach the lifting gear only to the main frame because only the main frame can carry the weight.
- Secure the device always against tilting, falling down or slipping.
- Do not stay in the tilting area of the device.
- Do not tilt the device more than indicated in the safety instructions regarding driving on the slope. Otherwise the device can tilt and the device can be damaged or contaminations can occur due to leaking fluid.
- Do not carry out tasks that can result in tilting, falling down or slipping of the device.

## Cleaning the device

Depending on use, clean the device thoroughly, especially the bottom and the blade.

Grass build-up and dirt that are stuck interfere with the grass ejection and impair the cutting quality.

For sufficient cooling of the hydrostat transmission, keep the gearbox casing and the area around the gearbox fan clean.

**Fire hazard!** Take particular care that the components at the muffler are clean.

For cleaning, use a hand brush. Remove stubborn dirt with a wooden or plastic spatula. Clean the outside housing parts with a cloth.

Do not clean the device with water spray or high-pressure cleaner! Do not use any aggressive cleaning agents.

## Cleaning the mower unit

### Notice

Cleaning agents damage the mower unit.

► Clean the mower unit with water only.

Clean the mower immediately after mowing. Avoid that the dirt dries up and is difficult to remove.

1. Switch off the engine and wait until the blade comes to a standstill.
2. Turn the cutting height limitation until the blade is in maintenance and cleaning position.
3. Clean the mower with water. A strong water jet improves the cleaning effect.

## Cleaning engine cooling

A dirty ventilation grid causes overheating of the engine which can result in engine damage. To sufficiently cool the engine, keep the engine cover, ventilation grid and engine clean.

Keep the ventilation grids free of dirt even during operation.

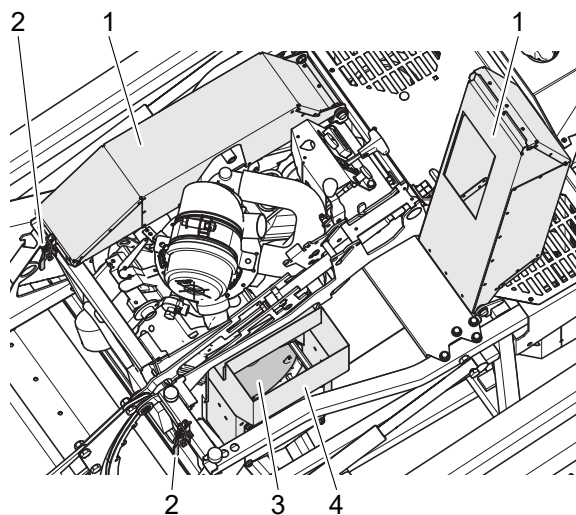

1. Switch off the engine.
2. Remove dirt from both ventilation grids (1).
3. Release the tension lock (2) and open the ventilation grid (1).
4. Clean the round cooling air grille (3) of the engine.
5. Clean the cooling air duct (4), especially the inside.
6. Close the ventilation grid (1) and secure it with the tension lock (2).



### General inspection

To make sure that the device can be operated safely, check all nuts, bolts, screws, connection of fuel lines, air filters etc. regularly for firm seating. Check the ignition wire and the spark plug connectors for damage.

Immediately replace damaged or worn parts, especially covers, protection skirt, muffler or fuel tank (authorised service centre).

Check all parts that contain fluids for leaks and proper condition. These can be: Fuel tank, fuel valve, fuel lines, carburetor, engine, gears, battery, hydraulic system.

In case of leaks, contact an authorised service centre.

### Check receiver and Remote Control Transmitter

Have the receiver and Remote Control Transmitter regularly checked by an authorised service centre. Please note that local regulations may apply.

If the device is used commercially, special local requirements may apply. For information contact local authorities, if necessary.

### Checking main switch

1. Switch on the device using the main switch.
  - ⇒ The LED "POWER" on the receiver must light up.
2. Switch off the device using the main switch.
  - ⇒ The LED "POWER" on the receiver must go out.
3. Remove the key from the main switch.
  - ⇒ The key must only be removable in position 0.

### Checking the safety functions

#### ⚠ Warning

Risk of injury caused by unexpected movement. When tests are carried out, the device can move unexpectedly.

- ▶ Carry out the tests on a sufficiently large and clear area without obstacles.
- ▶ Make sure that no persons, children, animals or objects are in the danger area.
- ▶ Observe the safety instructions at the beginning of the chapter "Maintenance".

#### ⚠ Warning

Risk of injury from the rotating blade and ejected objects.

- ▶ Make sure that no persons, children, animals or objects are in the danger area.
- ▶ Keep your hands and feet away from the rotating parts.
- ▶ Only engage the blade when it can rotate freely and does not touch objects or the ground.

Contact an authorised service centre if you notice any abnormal behaviour during the tests.

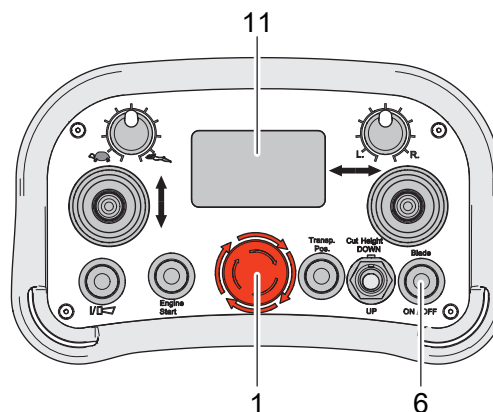

### Preparation

1. Switch on the transmitter and the receiver.
2. Start the engine.
3. Drive on large, open and level terrain.

### Checking start-stop switch

1. Press the button "Blade clutch" (6).
  - ⇒ The blade must be engaged.
2. Drive slowly forward.
3. Press the start-stop switch (1) on the transmitter.
  - ⇒ The blade must be disengaged.
  - ⇒ The engine must stop.
  - ⇒ The status indicator must stop flashing.
  - ⇒ The drive goes to neutral position, the parking brake is active.
  - ⇒ Engine start, drive and blade clutch must no longer be operable via the Remote Control Transmitter.

### Checking the Emergency stop switch

1. Press the button "Blade clutch" (6).
  - ⇒ The blade must be engaged.
2. Press the Emergency stop switch on the device.
  - ⇒ The blade must be disengaged.
  - ⇒ The engine must stop.
  - ⇒ The status indicator must stop flashing.
  - ⇒ The drive goes to neutral position, the parking brake is active.
  - ⇒ Engine start, drive and blade clutch must no longer be operable via the Remote Control Transmitter.

### Checking maintenance and cleaning position of the blade

1. Press the button "Blade clutch" (6).
  - ⇒ The blade must be engaged.
2. Turn the cutting height limitation until the blade is in maintenance and cleaning position.
  - ⇒ The cutting height indicator must be above 5.
  - ⇒ The blade must be disengaged.
  - ⇒ The status indicator must stop flashing.
  - ⇒ Now the blade should not engage.

### Checking the automatic blade switchoff

1. Press the button "Blade clutch" (6).
  - ⇒ The blade must be engaged.
2. Do not activate any control element on the Remote Control Transmitter for 2 minutes.
  - ⇒ The blade must be switched off automatically after these 2 minutes.
  - ⇒ The status indicator must stop flashing.
  - ⇒ In the display (11) the error code "C2" must be displayed.

### Checking the RC functions

#### ⚠ Warning

Risk of injury caused by unexpected movement. When tests are carried out, the device can move unexpectedly.

- ▶ Carry out the tests on a sufficiently large and clear area without obstacles.
- ▶ Make sure that no persons, children, animals or objects are in the danger area.
- ▶ Observe the safety instructions at the beginning of the chapter "Maintenance".

#### ⚠ Warning

Risk of injury from the rotating blade and ejected objects.

- ▶ Make sure that no persons, children, animals or objects are in the danger area.
- ▶ Keep your hands and feet away from the rotating parts.
- ▶ Only engage the blade when it can rotate freely and does not touch objects or the ground.

The RC functions are tested while the engine is running.

Contact an authorised service centre if you notice any abnormal behaviour during the tests or if, for example, the steering trim cannot be adjusted correctly.

The control may need to be calibrated by an authorised service centre or there may be mechanical problems.

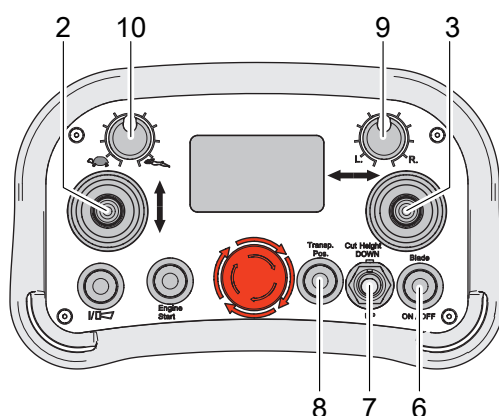

### Checking the traction drive

1. Switch on the transmitter and the receiver.
2. Set the rotary knob "maximum travel speed" (10) to rabbit.
3. Start the engine.
  - ⇒ The device must be stopped.

4. Pull the accelerator lever all the way up.
    - ⇒ The engine is idling.
  5. Press the left joystick (2) forward.
    - ⇒ The device must move forward.
  6. Press the left joystick (2) backwards.
    - ⇒ The device must move backwards.
  7. Release the left joystick (2).
    - ⇒ The device must stop and stand still.
- Perform all further tests exclusively with idle throttle.

### Checking steering when stationary

1. Press the right joystick (3) slowly to the left.
  - ⇒ The device rotates slowly on the spot to the left. The left chain moves backwards, the right chain moves forward.
2. Press the right joystick (3) slowly to the right.
  - ⇒ The device rotates slowly on the spot to the right. The left chain moves forward, the right chain moves backwards.

The further you push the right joystick (3), the faster the device rotates.

### Checking and adjusting steering trim

When steering while stationary, the steering trim has no effect.

1. Slowly press the left joystick (2) forward.
  - ⇒ The device should move straight forward.
2. When the device moves to the left: Turn the rotary knob "Trim steering" (9) to the right until the device drives straight ahead.
3. When the device moves to the right: Turn the rotary knob "Trim steering" (9) to the left until the device moves straight ahead.

### Checking steering while driving

1. Press the left joystick (2) slowly forward – the device must move forward.
2. Press the right joystick (3) slowly to the left.
  - ⇒ The device curves to the left.
3. Press the right joystick (3) slowly to the right.
  - ⇒ The device curves to the right.

The function of the steering depends on the driving speed.

- If you press the joystick (3) completely during high speed, the device curves.
- If you completely press the joystick (3) at a slow driving speed, the curve-inner chain moves backwards.

### Check cutting height and blade clutch

1. Press the toggle switch "cutting height" (7) forwards and backwards.
  - ⇒ The cutting height must change.
  - ⇒ The cutting height display on the device must show the cutting height.
2. Press the button "Blade clutch" (6).
  - ⇒ It must be possible to engage and disengage the knife at any cutting height.
  - ⇒ When the blade is engaged, the status indicator must flash.

### Check transport position

1. Press the button "Blade clutch" (6).
  - ⇒ The blade must be engaged.
2. Press the button "Transport position blade" (8).
  - ⇒ The blade must be disengaged.
  - ⇒ The blade must move to the highest cutting height.
  - ⇒ The cutting height display on the device must be set to 5.
  - ⇒ The status indicator must stop flashing.

### Checking the parking brake

#### ⚠ Warning

If the parking brake is not properly adjusted, the device can roll away.

- Make sure that the parking brake always functions correctly.

1. Drive the device uphill into terrain with a 30° to 40° slope.
2. Stop the device.
  - ⇒ The device must remain stationary and not roll downhill.

If the chains lock up, the parking brake is set correctly.

If the device moves, the parking brake must be readjusted by an authorised service centre.

### Checking the blade and flail shaft

#### ⚠ Warning

Wear or damage on the blades and the fastening elements can result in the blades or the fastening elements coming off.

- Check the blades and all fastening elements according to the following instructions.

#### ⚠ Warning

There is a considerable risk of injury due to improperly mounted and maintained blades.

- Work at blades must be carried out by an authorised service centre.

Working with the blade and the blade shaft requires special skills and therefore may only be carried out by an authorised service centre.

All shown blade parts and their fastening elements must be changed

- if damage or cracks are detected.
- if unusually strong vibrations occur.
- at least once a year or every 50 operating hours, no matter if wear does exist or not.

The material weakens, can suffer cracks, endangering people and material assets. Ejected broken pieces can cause severe injuries.

Unusual vibrations are an indication that

- blades are missing or broken,
- the blade is worn excessively or on one side or
- damage to the engine or cutter deck fastening.

### Changing the flail blades

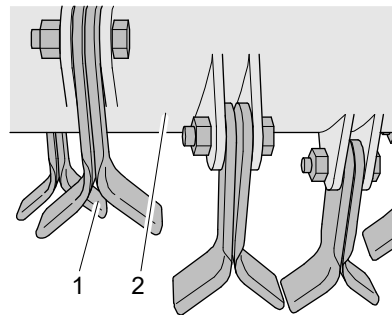

#### New blade

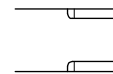

#### Replacing blade

- broken

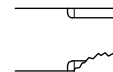

- bent



- worn on both sides

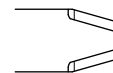

#### Turning blade

- worn on one side

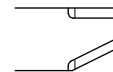

The flail blades (1) can be mounted on both sides. Turn all flail blades together if:

- one side is used and
- the other side of the flail blade has not been used yet.

Replace a flail blade if the blade:

- broken,
- torn,
- bent or
- worn on both sides.

If wear is uneven, there is a risk of imbalance.

Replace all flail blades together if more than 2 flail blades are damaged or worn.

For each blade change, check the flail shaft (2) for damage and cracks.

Always have a replacement blade ready.

## Original blade

An original blade is engraved with:

AS XXXXXXXX

The engraving shows the spare part number.

## Checking the fastening elements and the flail shaft

### ⚠ Warning

Wear or damage at the flail shaft and the fastening elements can result in the flail blade or the fastening elements coming off.

- Check the flail shaft, mounting plates, fastening screws and corresponding nuts of the flail blades.

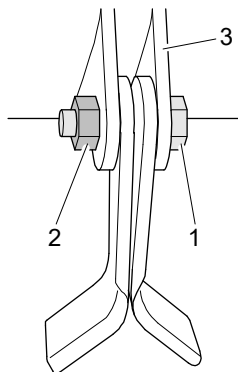

The fastening elements are worn down during mowing. Replace the fastening screws (1) and the corresponding nuts (2),

- if they are worn by more than 0.04 in (1 mm) in diameter and
- for each blade change.

Only use original spare parts.

For each blade change, check the flail shaft for damage. The fastening straps (3) must not be damaged, bent or knocked out. Contact an authorised service centre if damage, cracks or wear have occurred.

## Checking the blade brake clutch

1. Switch on the transmitter and the receiver.
2. Start the engine.
3. Move on a terrain where the blade can rotate freely and does not touch objects or the ground.
4. Make sure that nobody is in the danger area of the device.
5. Turn the accelerator lever to the maximum engine speed.
6. Engage the blade.
7. Disengage the blade.
  - ⇒ The blade must stop from maximum speed in less than 7 seconds.
  - ⇒ The status indicator must stop flashing.

## Checking chains

### Checking the condition of the chains

Check the chains for completeness, wear, damage and cracks.

- each time before and after you mow.

Contact an authorised service centre if you determine faults or damage during the inspection.

The chains must be changed

- If damage or cracks are found.
- if the cleats of the chains are worn out.
- if the steel cables of the chains are exposed.
- if broken steel cables are visible.

Change the chains in pairs.

### Checking chain tension

#### Notice

Risk of damage due to incorrectly tensioned chains.

- Always make sure that the chains are correctly tensioned.

Chains that are not sufficiently tensioned can come loose from the device while driving.

Excessively tensioned chains increase the load on the device and cause damage to the chains and the frame of the device.

Correct chain tension protects the chains and the frame of the device from overload. The chain tension is correctly adjusted when the length of the spring assembly (5) is 125 mm.

The spring assembly (5) is accessible from the top.

### Tensioning chains

You can carry out the work described below while the device is standing on a level surface.

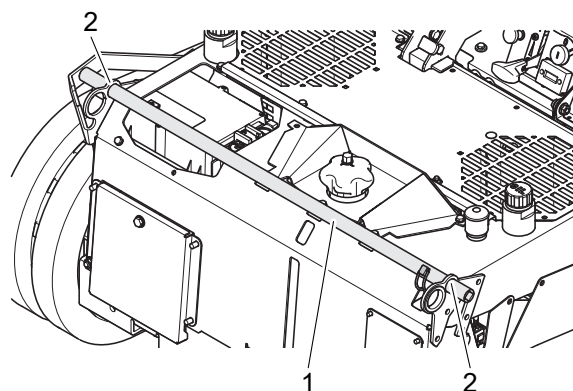

1. Loosen the securing splint and remove the extension (1) from the holder (2).

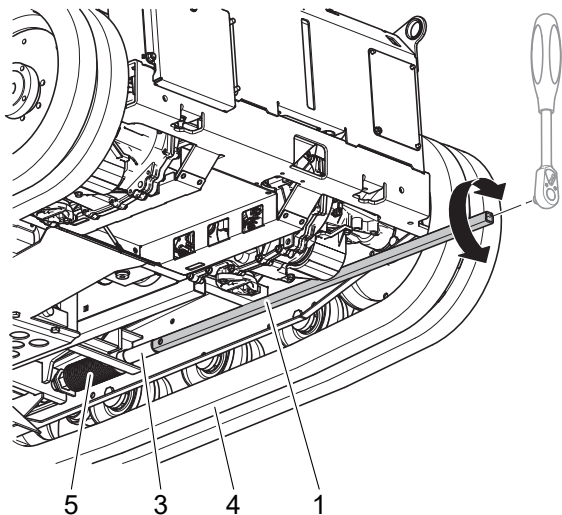

2. Insert the extension (1) from the back of the device and pass it under the device.
3. Set the extension (1) on the square (3).
4. Place a 1/2" socket wrench handle on the extension (1) and turn the square (3) clockwise to tension the chain (4).

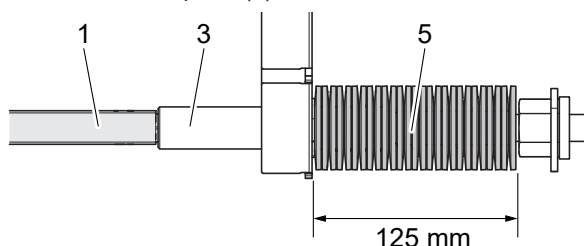

5. Tension the chain so that the spring pack (5) has a length of 125 mm.
6. Tension the other chain in the same way.
7. Put the extension (1) back into the holder (2) and fasten it with the securing splint pin.

## Maintaining the engine

### **⚠ Danger**

The ignition system generates an electromagnetic field.  
► Wearers of pacemakers must not work on active parts.

### **⚠ Caution**

If the speed is set too high, objects can be ejected. The engine can be damaged and a higher level of noise pollution is produced.  
► Do not change the basic setting of the carburetor or the speed control.

The engine manufacturer has prepared the operating manual of the engine. The manual contains all maintenance requirements and warranty conditions for the engine. If warranty work at the engine is required, contact your authorised service centre or the next authorised dealer for engines.

To ensure a long service life of the engine, sufficient engine cooling is required.

Keep the

- engine cover (ventilation grid),
  - muffler (protective grid) and
  - cooling fins of the engine
- clean at all times.

## Checking the engine oil level

### Notice

Incorrect oil level can damage the engine.

- Prior to each use, check the engine oil level.

The oil level may never be too low; otherwise, the engine can be damaged. When moving on slopes, the oil level should always be at the top level.

Never fill in too much oil. Otherwise, there is a risk that oil enter the air filter and destroys it.

Observe the information in the operator's manual of the engine manufacturer.

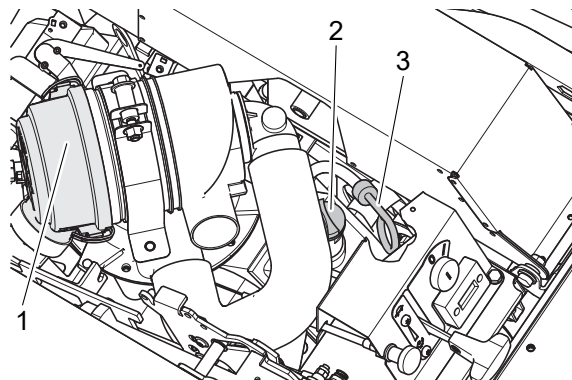

1: Air filter

2: Oil filler neck

3: Oil dipstick



## Check oil level of the bevel gear

### Notice

Incorrect oil level can damage the bevel gear.

- Prior to each use, check the oil level.

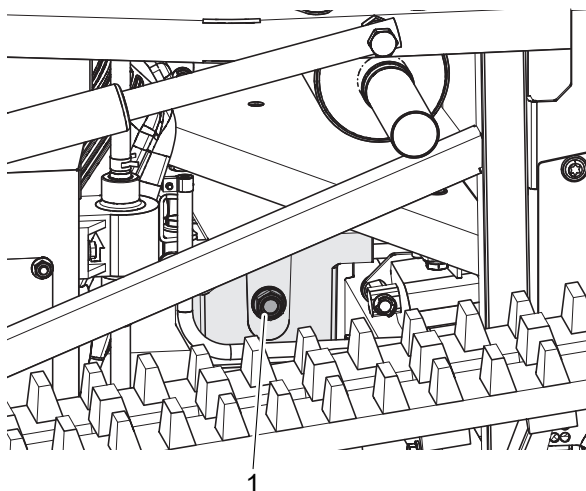

Place the device for 30 minutes on a level surface before you check the oil level.

The inspection glass (1) should be at least 1/2 full of oil.



If the oil level is lower than 1/3 of the inspection glass, damage to the gearbox due to overheating can result.

Contact an authorised service centre when the oil level is too low.

## Maintaining the air filter

### Warning

There is a fire and explosion risk due to cleaning agents.

- Never clean the air filter with flammable solvents.

Make sure that the air filter is always clean. A dirty air filter reduces the engine power and leads to increased engine wear and fuel consumption. Independent of the operating hours, change the filter insert at least once a year. Do not operate the engine without air filter.

Observe the information in the operator's manual of the engine manufacturer.

## Checking and charging the battery

### Warning

Batteries can be dangerous.

- Keep children away.
- Never perform any changes to the battery.
- The battery is sealed and may never be opened.
- For all work on the battery or the battery cables, wear safety glasses and gloves.
- If accidents with battery acid occur, always contact a doctor.

### Warning

Explosion hazard

When the battery is charged, explosive gases are generated. An explosion of the battery can result in injuries and blindness.

- Keep open flames and ignition sources away and do not smoke.
- Charge the battery only in well ventilated rooms.

### Warning

Danger of chemical burn

Batteries contain acids. Contact with battery acid can result in blindness or serious burns.

- Always keep the battery upright and do not spill any battery acid.
- Avoid contact with skin and eyes.
- If battery acid comes into contact with eyes, immediately rinse the eyes with water.

### Warning

When you work on the battery, there is a risk of short circuit.

- Do not put any tools or metal objects onto the battery.
- When disconnecting and connecting the battery, observe the order of assembly steps.

### Notice

Work on the battery can damage the receiver.

- Press the start-stop switch on the transmitter. Switch off the device at the main switch and remove the key.

During operation, the battery voltage of the device is displayed on the display of the Remote Control Transmitter.

If the starter does not get the engine going or only insufficiently, charge the battery.

Use electronically controlled charging systems. These charging systems detect the connected battery and charge it with the required charging current and terminate the charging process when the battery is full.



## Maintenance

Use a charger that is equipped with a 12 V connection for standard norm outlets. Insert the plug for charging into the standard norm outlet.

Charge the battery before you put the device away for winter storage. A fully charged battery lasts for approx. 4 months before it needs to be recharged.

### Exchanging the battery

#### ⚠ Warning

When you work on the battery, there is a risk of short circuit.

- ▶ Do not put any tools or metal objects onto the battery.
- ▶ When disconnecting and connecting the battery, observe the order of assembly steps.

**Important:** Only use original batteries.

You can buy original batteries from the manufacturer or your authorised service centre. Also observe all information in the operator's manual of the battery (if existing).

**Beware!** Never confuse the plus and minus terminals.

1. Disconnect the black cable (-).
2. Disconnect the red cable (+).
3. Dismantle the battery from the device.
4. Mount the new battery into the device.
5. Connect the red cable (+).
6. Connect the black cable (-).

### Hydrostat transmission

#### ⚠ Warning

Risk of injury due to high pressure in the hydraulic system.

- ▶ Check the hydraulic drive system for leaks, damage and chafe points.

#### ⚠ Warning

When oil leaks there is a danger of environmental pollution.

- ▶ Check the hydraulic drive system for leaks before and after mowing.

Oil changes must be carried out by authorised service centre (see chapter "Maintenance overview").

Check if the gearbox fan is undamaged.

The hydrostatic drive generates a monotone working noise that gets louder as the load is increased (e.g. in steep terrain). If the working noise changes, if it gets irregular or very loud, let the hydrostatic drive cool down. If the changed working noise still exists, have the device checked by an authorised service centre.

## Grease lubrication

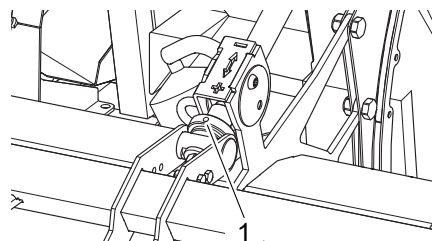
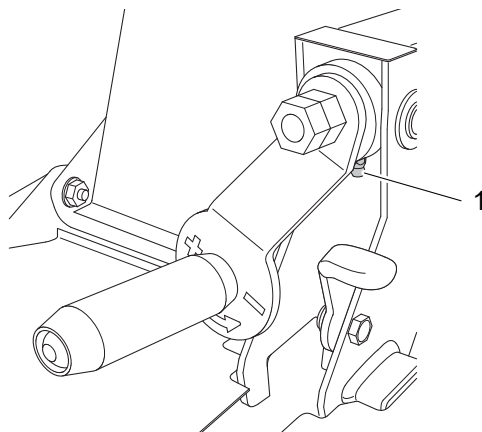

A grease nipple (1) is attached to the cutting height adjustment and the cutting height limitation.

1. Clean the lubricating nipples.
2. Lubricate the lubricating nipples with a grease gun (1-2 strokes pressure-resistant grease).
3. Remove excess grease that has been pressed out of the bearing points.
4. Clean the spindles, especially if they are dirty or sluggish.
5. Grease the spindles.

## Assembly

### Scope of delivery

The device is shipped in a carton on a pallet. The scope of delivery includes:

- The device.
- The transmitter with batteries and belts.
- Key for main switch.
- Tool bag with small parts.
- This operating manual.
- Manufacturer's certificate.
- Operator's manual of the engine manufacturer.

### Unpacking

1. Remove the box.
2. Insert the batteries into the Remote Control Transmitter (see chapter "Checking and changing the battery of the transmitter").
3. Attach the belt to the transmitter.
4. Remove the spare key and keep it in a safe place.

## Storage

### Danger

Danger of poisoning due to poisonous exhaust gases.

- ▶ Do not operate the engine in closed or insufficiently ventilated rooms.
- ▶ Please observe the safety instructions regarding the poisoning risk.

### Warning

Fire hazard

Parts of the device can become extremely hot during operation and this may cause fire.

- ▶ Please observe the safety instruction regarding the fire risk.

### Warning

There is a risk of injury in case of unauthorised use.

- ▶ Press the start-stop switch on the transmitter. Switch off the device at the main switch and remove the key.

## Storing the device

Store the device in a locked, dry and sufficiently ventilated room and out of reach of children. Always rectify faults of the device before storage so that the device is always in operationally safe condition. Let the device cool down for at least 20 minutes before you store it.

Also observe the information regarding storage in the operator's manual of the engine manufacturer.

### Longer storage

1. Observe the safety instructions for handling the fuel.
2. Run the fuel tank empty.
3. Emptying carburetor: Close the fuel valve, start the engine and let it run until it stops by itself.
4. Thoroughly clean the device.
5. Touch up any possible damage to the paint finish (for paint, see chapter "Accessories").
6. Remove the key from the main switch and store it separately from the device.
7. Remove the batteries from the transmitter.

Before longer storage, e.g. in the fall, have an authorised service centre check the device!

Also observe the information regarding storage in the operator's manual of the engine manufacturer.

### Restarting

If you want to start the device after a longer storage, carry out the tasks described in chapter "Maintenance".

### Spare parts

The reliable and safe operation of the device also depends on the quality of the spare parts used. Only use original spare parts and accessories approved by the manufacturer. When foreign parts are installed, the warranty and guarantee shall be void for the foreign parts, the device, and for any resulting damage.

Inform your authorised service centre about the device type and serial number of your device when you order spare parts.

Via [www.as-motor.com](http://www.as-motor.com) you have direct access to our spare parts portal. Here you can quickly find the right spare part using the search function and print out the corresponding spare parts list. This makes it easier for you to place the subsequent order via your authorised specialist workshop, stating the device type and the serial number of your device.

### Wear parts

Some parts are described as wear parts. They wear during use and must be replaced. The warranty does not cover the following parts (examples):

Blades, cutting edges, cutter bars, blade bolts, sliding plates, V-belts, chains, Bowden cables, starter ropes, pressure plates, air filters, spark plugs, disk springs, lock washers, fuses, disks, thrust plates, pressure disks, protection skirts, impact protection, wheels, tires, brushes, sliders etc.

### Disposal and recycling

Lawn cuttings should not be thrown in the trash but should be composted.

Shredded plant material decomposes quickly and can be used as fertilizer and, therefore, be left on the ground.

Dispose of waste oil and fuel in accordance with the local regulations or return it to an oil shop.



The symbol of the crossed-out wheeled garbage can means that this product and the battery/batteries it may contain must be disposed of separately from household waste. As the end user, you are obligated to dispose of the product and the battery/batteries separately in accordance with the respective national regulations, for example by taking them to an official collection point. It is also possible to return them to a retailer if the distributor offers to take them back voluntarily or is legally obligated to do so.

Please note that used batteries and accumulators that are not enclosed in the old appliance and that can be removed from the old appliance without causing damage must be separated from the old appliance before it is handed in.

By collecting them separately, you make a valuable contribution to protecting the environment and human health, as the proper treatment of old appliances avoids potentially negative effects caused by the presence of hazardous substances and conserves raw materials by recovering them.

Please also note that waste avoidance makes an even more valuable contribution to environmental protection. Where possible, therefore, in addition to continuing to use or repair them yourself, passing on to second users is also an ecologically valuable alternative to disposal.

### Warranty

Please see our homepage [www.as-motor.com](http://www.as-motor.com) for warranty conditions.

Please print out the documents that you receive during the online registration. Keep these together with your proof of purchase.

## Troubleshooting

If a fault occurs, it is recommended to first switch off the Remote Control Transmitter using the start-stop switch and the device using the main switch. Wait 10 seconds and restart the device. If necessary, also change the radio channel (see chapter "Selecting the radio channel").

If the fault persists, the following list and the list "Error codes" can help you to detect the faults that occur most frequently and how to eliminate them.

If the fault cannot be eliminated, contact your closest authorised service centre.

You can find an authorised service centre on our home page under [www.as-motor.com](http://www.as-motor.com).

Problem	Possible cause	Remedy
<b>No connection between Remote Control Transmitter and receiver</b>	Radio connection is not established (in the display the mode "SCAN" is displayed).	Check LED display on the receiver. Wait until the radio connection is established (in the display, the mode "STOP" is shown).
	Receiver malfunction.	Check the receiver (authorised service centre).
	Battery in the Remote Control Transmitter is empty.	Replace battery.
	Battery in the device is empty.	Charge battery (see chapter "Checking and charging the battery") or authorised service centre.
	Radio range exceeded.	Reduce distance between Remote Control Transmitter and receiver.
	Radio interference due to other Remote Control Transmitters (radio equipment, garage door opener, vehicle key).	Switch off Remote Control Transmitter and receiver, restart after 10 seconds.
		Switch the radio channel.
		Increase the distance to the disturbance source. Remove the disturbance source.
	Antenna loose, damaged or no longer existent.	Fasten or replace antenna.
<b>No display on Remote Control Transmitter</b>	Remote Control Transmitter is switched off.	Switch on the Remote Control Transmitter.
	Battery in the Remote Control Transmitter is empty.	Replace battery.
	Battery compartment defective (e.g. corrosion or battery leaked)	Check and clean battery compartment (authorised service centre).
<b>Operating time of Remote Control Transmitter too short</b>	Battery in the Remote Control Transmitter is empty.	Replace battery.
	Wrong battery inserted.	Insert correct batteries (see chapter "Technical specifications")
<b>Starter does not turn</b>	An Emergency stop situation occurred.	Eliminate the Emergency Stop situation (see chapter "Procedure after an Emergency stop").
	Fuse is defective.	Replace (if necessary, have authorised service centre do so).
	Battery in the device is empty.	Charge the battery (see chapter "Checking and charging the battery") or contact authorised service centre.
	Battery in the device is defective.	Replace battery (authorised service centre).

## Troubleshooting

Problem	Possible cause	Remedy
<b>Engine does not start</b>	Fuel valve is closed.	Open fuel valve.
	Tank ventilation screw is closed.	Open tank ventilation screw.
	No fuel is in the tank.	Refill fuel.
	Choke is open.	Close the choke.
	Device was tilted – oil leaked into the air filter.	Replace air filter, unscrew spark plug and start several times when the fuel valve is closed, dry the spark plug and screw it back in.
	Engine was flooded due to too many start attempts.	Unscrew spark plugs and start several times when the fuel valve is closed, dry the spark plugs and screw them back in.
	Spark plug connector is pulled off.	Observe the safety instructions! Put spark plug connector back on.
	Air filter is dirty.	Maintain air filter (see chapter “Maintenance”).
	Spark plugs are dirty, damaged, or incorrect electrode gap.	Clean spark plugs and check electrode gap (see chapter “Maintenance”). Replace spark plugs if necessary.
	Poor quality, dirty, or old fuel.	Clean fuel system (authorised service centre). Always use fresh fuel.
<b>Engine starts badly or runs irregularly</b>	Choke is closed.	Open choke (see chapter “Starting the engine”).
	Air filter is dirty.	Maintain air filter (see chapter “Maintenance”).
	Poor quality, dirty, or old fuel.	Always use fresh fuel.
	Spark plug is dirty, damaged, or incorrect electrode gap.	Clean spark plug and check electrode gap (see chapter “Maintenance”). Replace spark plug if necessary.
<b>Engine stops during operation</b>	Battery in the Remote Control Transmitter is empty.	Replace battery.
	Battery in the device is empty.	Charge the battery (see chapter “Checking and charging the battery”) or contact authorised service centre.
<b>Device does not move</b>	Rotary knob limit speed is set to “turtle”.	Adjust rotary knob limit speed.
	Hydrostatic drive is overheated.	Cool down (see chapter “Maintenance”).
<b>Blade cannot be engaged</b>	Mower in maintenance and cleaning position.	Move mower to desired cutting position.
	V-belt is damaged.	Authorised service centre.
<b>The blade does not rotate</b>	V-belt is insufficiently tensioned or damaged.	Authorised service centre.
	Bowden cable is defective.	Authorised service centre.
<b>Strong vibrations during operation</b>	Imbalance due to missing, broken, chipped or unevenly worn blades.	Check blade and flail shaft (see chapter “Maintenance”).
	Flail shaft is bent due to collisions with foreign objects.	Authorised service centre.
	Engine fastening is loose.	Authorised service centre.
	Blade fastening is loose.	Authorised service centre.
<b>Irregular noises</b>	Loose fastening elements.	authorised service centre.
	Muffler is defective.	authorised service centre.
	Hydrostatic drive is overheated.	Cool down (see chapter “Maintenance”).
<b>Engine is smoking</b>	Air filter is dirty or drenched with oil.	Maintain or replace air filter (see chapter “Maintenance”).
	Oil level is too high.	Have authorised service centre lower the oil level to the marking.

Problem	Possible cause	Remedy
<b>Engine gets hot</b>	Ventilation grid is dirty.	Clean ventilation grid.
	Oil level in the engine is too low.	Refill engine oil (see operator's manual of the engine manufacturer).
	Cooling fins of the engine are dirty.	Have cooling fins cleaned by authorised service centre.
<b>Unclean cut</b>	Blade is dull or worn.	Have damaged blades replace immediately (authorised service centre).
	Speed is too high proportionate to the cutting height.	Reduce speed and/or select the correct cutting height.
	Housing of the device is heavily contaminated.	Clean.
	Mower housing is not parallel to the ground.	Adjust (authorised service centre).
<b>Mulching result of thick brush not satisfactory</b>	Speed is too high.	Reduce speed.
<b>Mulching result of normal brush not satisfactory</b>	Mulched material is ejected too quickly.	Increase speed.
<b>Housing is jammed</b>	Mowed grass was too long or too damp.	Adjust cutting height and mowing speed to the mowing conditions.
	Blade is worn.	authorised service centre.
	Engine speed is too low despite full power.	authorised service centre.
<b>The device does not stop when the brake is activated</b>	Brake is adjusted incorrectly, worn, or defective.	Check parking brake (see chapter "Maintenance"). authorised service centre.
<b>The engine does not switch off</b>	Switching off system is defective.	Press the Emergency stop switch on the device. Close the fuel valve. authorised service centre.
<b>Device does not drive straight forward</b>	Trimming of the steering is not adjusted.	Adjust the trim using the „Steering trim“ knob on the Remote Control Transmitter (if required, authorised service centre).
<b>Chain detaches from the device</b>	Chain incorrectly tensioned.	Chain correctly tensioned.
	Foreign object in the drive.	Remove foreign object.
	Chain, sprocket or wheels worn or damaged.	Replace worn or damaged parts (authorised service centre).



### Error codes

When the receiver detects an error, an error code is displayed on the display of the Remote Control Transmitter.

The following table lists the most frequent error codes. Contact an authorised service centre when an error code is displayed that you cannot find in this table.

Display	Designation	Reasons	Remedy
<b>A3</b>	Activate the Emergency stop switch on the device	Emergency stop switch activated.	Unlock the Emergency stop switch by turning clockwise.
<b>A9</b>	Emergency stop caused by inclined position	Emergency Stop due to inclination (maximum slope has been exceeded or the device has tipped over).	Recover device.
		Emergency stop caused by strong vibrations and impacts.	Drive slower in uneven terrain. If necessary, check chain tension.
<b>C2</b>	Blade switches off after 2 minutes.	No activation of a transmitter function.	Engaging blade.
<b>F2</b>	Right drive actuator does not go to desired position.	Drive lever / rods blocked on the right.	Remove blockage.
		Angle sensor defective or cable break.	Check device for cable break. Authorised service centre.
<b>F3</b>	Angle sensor driving right	Angle sensor defective or cable break.	Replace defective angle sensor and repair cable. Authorised service centre.
<b>F4</b>	Left drive actuator does not go to desired position.	Drive lever / rods blocked on the left.	Remove blockage.
		Angle sensor defective or cable break.	Check device for cable break. Authorised service centre.
<b>F5</b>	Angle sensor driving left	Angle sensor defective or cable break.	Replace defective angle sensor and repair cable. Authorised service centre.

## Technical specifications

Type	AS 1000 OVIS EVO RC
<b>Range of application (temperature)</b>	0 - 30 °C For temperatures below 5 °C, observe the engine manufacturer's information regarding the engine oil.
<b>Engine</b> , type Manufacturer Type Cylinder capacity Performance Engine speed	Two-cylinder four-stroke engine Briggs & Stratton Vanguard, V-Twin 627 cm <sup>3</sup> 15.5 kW (21.1 PS) 3,600 min <sup>-1</sup>
<b>Starting device</b>	Electric start
<b>Battery</b> , device	12 V, 22 Ah
<b>Receiver and Remote Control Transmitter</b> Manufacturer Control type Frequency range Range Battery Remote Control Transmitter Registration Standard or relevant regulations	Hatox Wireless proportional mobile control 434 MHz (EU) 300 m 2x AA 1.5 V or 2x AA 1.2 V NiMH batteries (not included in the scope of delivery) RED, FCC IEC 61508-3, DIN EN 62745:2017-12
<b>Traction drive</b> Speed forward Speed reverse	Crawler chain 0 - 5.0 km/h 0 - 5.0 km/h
<b>Maximum area coverage</b>	approx. 5,000 m <sup>2</sup> /h
<b>Turning radius</b>	approx. 0 m
<b>Cutting device</b> , type Cutting width Continuous cutting height Maintenance and cleaning position Drive of cutting tool Clutch of cutting tool Growth height	Flail mower unit with 28 Y-knife, can be used on both sides. 100 cm 30 - 110 mm 700 mm V-belt Belt tension clutch up to approx. 150 cm
<b>Measures and weights</b> Transport size with packaging L/W/H max. operating dimensions L/W/H Weight	208/130/130 cm 183/114/69 cm 428 kg
<b>Capacities</b> Fuel tank Engine oil  Transmission oil (per device side)	12 litres, of which approx. 0.1 L reserve 1.7 litres 5W-50 fully synthetic engine oil (see operating instructions of the engine manufacturer) 2.1 Liter SAE 5W-50 fully synthetic engine oil
<b>Sound level</b>	according to DIN EN 12733
Measured sound power level L <sub>WA</sub> Uncertainty factor K <sub>WA</sub>	103.5 dB (A) 3.0 dB (A)
Measured sound pressure level L <sub>pA</sub> when operating behind the device  Uncertainty factor K <sub>pA</sub>	92.0 dB (A) Wear ear protection! 3.0 dB (A)
Measured sound pressure level L <sub>pA</sub> at a distance of 15 metres Uncertainty factor K <sub>pA</sub>	73.6 dB (A) 3.0 dB (A)
<b>Maximum slope</b> crosswise to the slope uphill and downhill	55° 44°

Technical specifications

Type	AS 1000 OVIS EVO RC
<b>Angle at which the device flips over</b> Measurement method  crosswise to the slope uphill and downhill	Measured angle at which the stationary device tips over (mower in highest position, tank full) 61° 49°

## Fuses

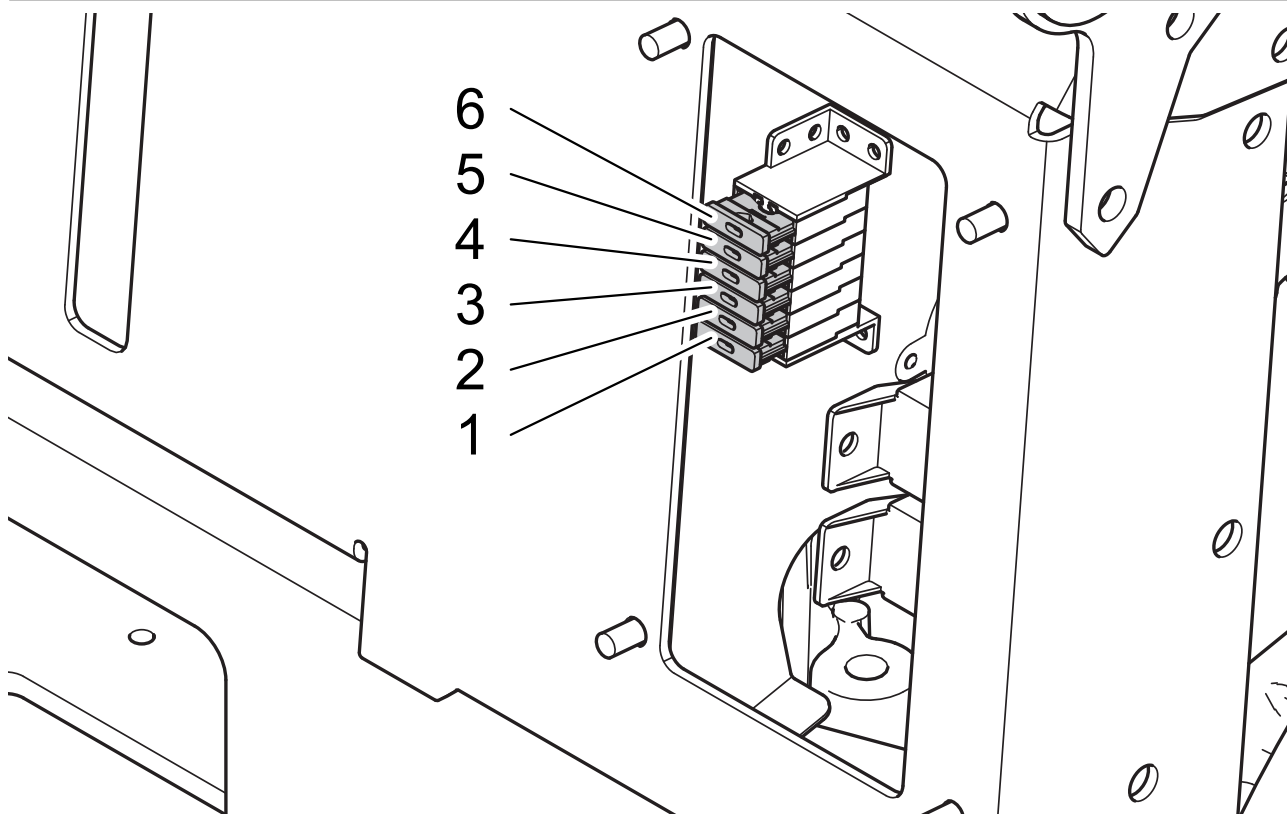

The fuses are located in the rear of the device.

If you notice any malfunctions, remove the fuse compartment cover and check the fuses. Replace defective fuses.

Contact an authorised service centre if the malfunction cannot be resolved by replacing the fuses or if the fuses blow again after replacement.

Do not carry out any repairs on the electrical system of the device.

Pos.	Rating	Designation	Supplied
1	25A	Main fuse 1	Receiver
2	25A	Main fuse 2	Receiver
3	25A	Main fuse 3	Receiver
4	25A	Fuse controller generator	Generator
5	10A	Fuse fuel pump Emergency stop	Fuel pump Emergency stop
6	10A	Fuse electrical socket	Power socket Ignition

Accessories

Spray can (orange colour):	G00011050
Inclinometer:	G06950027
Hammer flail set:	G90499004
Insect repellent device (without adapter):	G60099004
Adapter for insect scaring device AS 1000 OVIS RC:	G90599001
X-ACT TRACK steering assistant:	G90500201

**EC Declaration of conformity**

We declare that the grassland mowers

<b>Type</b>	<b>AS 1000 OVIS EVO RC</b>
Starting from serial no.	040724110001

as brought into circulation by us conform to all relevant safety and health requirements of the EC directives listed.

- 2006/42/EC
- 2014/30/EC
- 2014/53/EC (RED)
- 2011/65/EC (RoHs)

**Function:**

The device is intended for cutting and mulching grass or similar vegetation in agriculture, and forestry.

**Applied standards:**

DIN EN 12733  
ETSI EN 300220-1-2:2013-02  
EN 301489-1-3:2013-12  
EN 62479:2011-09  
EN 61326-1:2015-06  
EN 55011:2011-04  
EN 61000-6-3:2011-09  
EN 55012:2007 + A1:2009  
DIN EN ISO 14982:2009

**Place where all technical records are filed:**

AriensCo GmbH  
Ellwanger Straße 15  
74424 Bühlertann  
Germany

Bühlertann, in November 2024



Jochen Schneider  
Management



by proxy Frank Einsiedler  
Head of development





AriensCo GmbH  
Ellwanger Straße 15  
74424 Bühlertann  
Germany  
[www.as-motor.com](http://www.as-motor.com)



AS-Motor is your premium brand for lawn and high grass mowers as well as weed removers. We offer our customers professional technology for steep slopes, rough terrain, and lawn care. Our extensive product range which includes hand-held entry-level devices up to devices with remote control will always offer private customers, service providers, cities, municipalities and road maintenance authorities the right product. For more than 60 years, we have been developing and producing with a high production depth in Southern Germany and supply our dealer network in more than 45 countries all over the world.

<b>Mulching mower</b>	AS Mulching mowers shred the grass to create such a fine mulch, almost an “invisible” fertiliser, that sinks right away back into the lawn. Disposal of the cuttings is not required.
<b>Professional lawn mower</b>	Professional lawn mowers with rear or side discharge for every requirement, even with all-wheel drive, brake and reverse gear.
<b>Allmäher®</b>	An agile lawn mower for maintenance of extensive grassed areas. The Allmäher® reliably mows metre-high grass, brushes, and weeds.
<b>Flail mower</b>	High grass with undergrowth, steep slopes or areas in unknown terrain? The movably mounted flail blades of the AS-Motor flail mower give way to rocks and obstacles and ensure an even cutting pattern.
<b>Ride-on mower</b>	Large areas, weeds, undergrowth or enormous grass heights - the AS-Motor ride-on mowers are made for it. The all-wheel drive ride-on mowers are also perfect for rough terrain.
<b>Equipment carriers and attachments</b>	Equipment carriers from AS-Motor give flexibility for the professional service provider's daily routine. For example, for insect-friendly mowing, sweeping, snow clearing and even more.
<b>Remote control mower</b>	Steep slope mowing is a challenge for man and machine. Modern RC technology makes this hard work much easier and safer.
<b>Rotary mower</b>	Ideal for feed production in the non-professional segment. The grass is moved to the side, unshredded, in rows as swaths.
<b>Weed remover</b>	The AS-Motor weed removers mechanically clean paved areas and curb stones from growing weeds – quickly, safely, and efficiently.
<b>AS-Motor Electric</b>	The AS-Motor Electric drive sets new standards in performance, power and endurance. Devices with this drive offer comparable performance values to devices with combustion engine.

AS-Motor is a brand of the Ariens Company

**ARIENS** | CO  
EST. 1933